

STRUCTURE SCHEDULE						
NO.	STATION	OFFSET	BASELINE	MD STANDARD NO., TYPE	EL.	REMARKS
I-1	101+11	44' RT.	MD 108 WB	MD-378.11 PRECAST STANDARD DOUBLE OPENING TYPE K INLET OPEN-END GRATE	TBD	DOUBLE OPENING
I-2	101+63	131' RT.	MD 108 WB	MD-374.68 PRECAST OR CAST IN PLACE COG OPENING FOR 8" CURB	TBD	10' CURB OPENING
I-3	101+76	27' LT.	MD 108 WB	MD-374.66 PRECAST OR CAST IN PLACE SHALLOW COG INLET	TBD	10' CURB OPENING
I-4	103+44	36' RT.	MD 108 WB	MD-374.62 PRECAST OR CAST IN PLACE CIRCULAR COG INLET FOR 8" CURB	TBD	10' CURB OPENING
I-5	104+11	21' LT.	MD 108 WB	MD-374.62 PRECAST OR CAST IN PLACE CIRCULAR COG INLET FOR 8" CURB	TBD	15' CURB OPENING
I-6	106+12	21' LT.	MD 108 WB	MD-374.62 PRECAST OR CAST IN PLACE CIRCULAR COG INLET FOR 8" CURB	TBD	10' CURB OPENING
I-7	107+17	21' LT.	MD 108 WB	MD-374.62 PRECAST OR CAST IN PLACE CIRCULAR COG INLET FOR 8" CURB	TBD	10' CURB OPENING

STRUCTURE SCHEDULE						
NO.	STATION	OFFSET	BASELINE	MD STANDARD NO., TYPE	EL.	REMARKS
I-8	107+76	36' RT.	MD 108 WB	MD-374.62 PRECAST OR CAST IN PLACE CIRCULAR COG INLET FOR 8" CURB	TBD	10' CURB OPENING
MH-1	101+43	22' RT.	MD 108 WB	MD-384.03 60" DIAMETER PRECAST MANHOLE FOR 27" TO 36" PIPES	TBD	.
MH-2	104+10	29' LT.	MD 108 WB	MD-384.01 48" DIAMETER PRECAST MANHOLE FOR 12" TO 24" PIPES	TBD	.
S-1	101+57	51' LT.	MD 108 WB	MD-378.11 PRECAST STANDARD DOUBLE OPENING TYPE K INLET OPEN-END GRATE	TBD	.
S-2	101+47	39' RT.	MD 108 WB	MD-378.11 PRECAST STANDARD DOUBLE OPENING TYPE K INLET OPEN-END GRATE	TBD	.
ES-1	101+43	52' LT.	MD 108 WB	MD-368.01 STANDARD CONCRETE END SECTION ROUND CONCRETE PIPE	TBD	15" PIPE
ES-2	101+77	43' LT.	MD 108 WB	MD-368.01 STANDARD CONCRETE END SECTION ROUND CONCRETE PIPE	TBD	15" PIPE
C-1	102+30	47' RT.	MD 108 WB	PIPE CONNECTION	NA	18"
C-2	102+30	26' RT.	MD 108 WB	PIPE CONNECTION	NA	15"

PIPE SCHEDULE							
FROM	TO	SIZE	TYPE	LENGTH	INV. IN	INV. OUT	REMARKS
I-1	MH-1	18"	RCP, CLASS IV	35'	TBD	TBD	.
S-2	MH-1	15"	RCP, CLASS IV	13'	TBD	TBD	.
C-1	MH-1	18"	RCP, CLASS IV	88'	TBD	TBD	.
S-1	ES-1	15"	RCP, CLASS IV	12'	TBD	TBD	.
I-3	ES-2	15"	RCP, CLASS IV	14'	TBD	TBD	.
I-5	MH-2	18"	RCP, CLASS IV	4'	TBD	TBD	.
I-6	I-5	18"	RCP, CLASS IV	198'	TBD	TBD	.
I-7	I-6	18"	RCP, CLASS IV	101'	TBD	TBD	.
S-3	I-7	15"	RCP, CLASS IV	106'	TBD	TBD	.
I-8	C-2	15"	RCP, CLASS IV	4'	TBD	TBD	.

RIPRAP					
STATION	OFFSET	LENGTH	WIDTH	AREA (SY)	REMARKS
101+56	33' RT.	13'	8'	12	CLASS 1
101+58	127' RT.	8'	11'	10	CLASS 1

LIMIT OF WORK
T7108
CLARKSVILLE PIKE
STA. 101+00

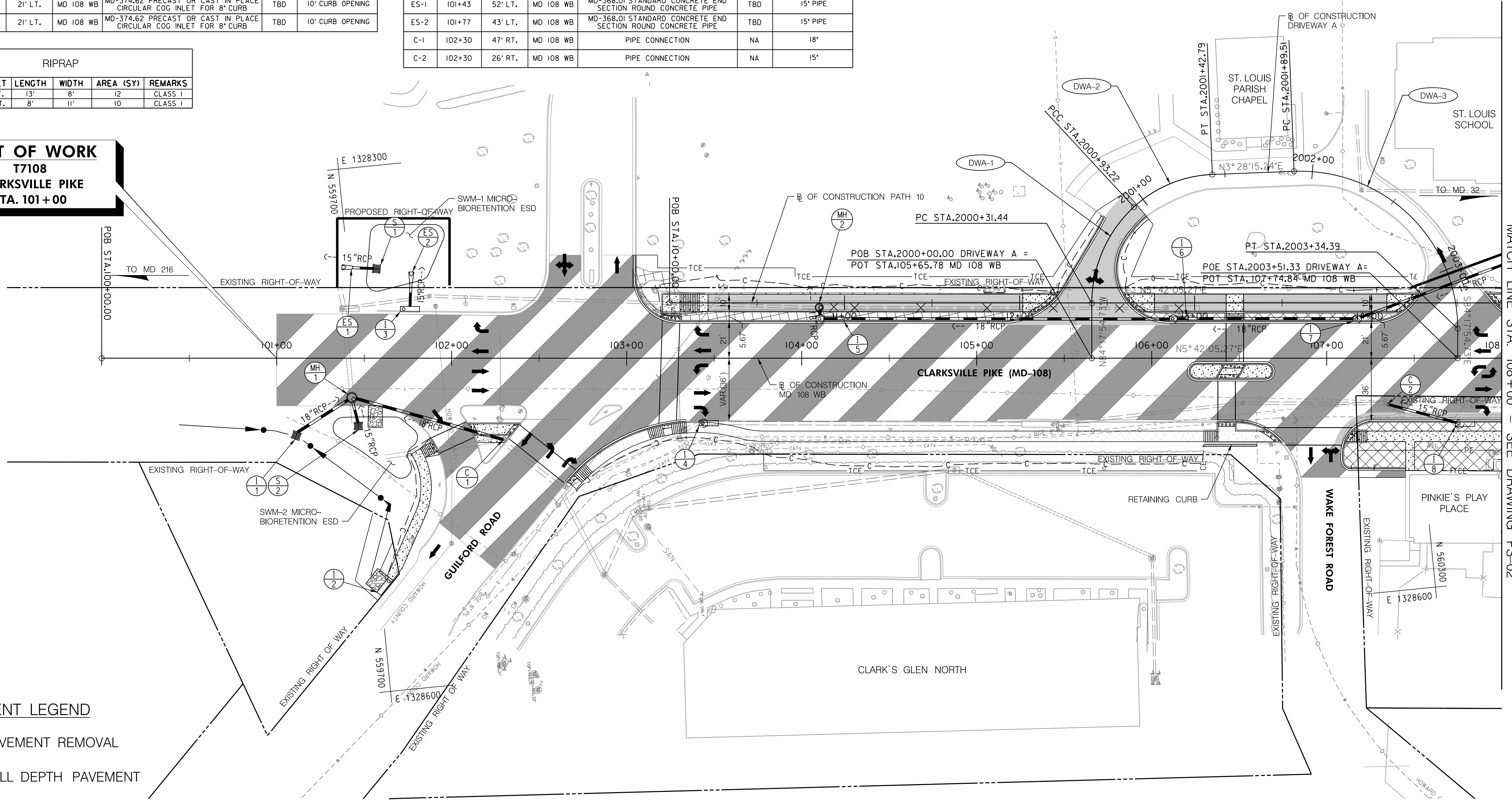

PAVEMENT LEGEND	
	PAVEMENT REMOVAL
	FULL DEPTH PAVEMENT
	FINE MILL AND OVERLAY
	ASPHALT SHARED USE PATH
	CONCRETE SIDEWALK

CURVE DATA						
CURVE	DELTA	Dc	R	L	T	E
DWA-1	47° 11' 48.29" RT	76° 23' 39.74"	75.00'	61.78'	32.77'	6.84'
DWA-2	40° 34' 21.67" RT	81° 51' 04.01"	70.00'	49.57'	25.87'	4.63'
DWA-3	92° 13' 50.03" RT	63° 39' 43.12"	90.00'	144.88'	93.57'	39.83'

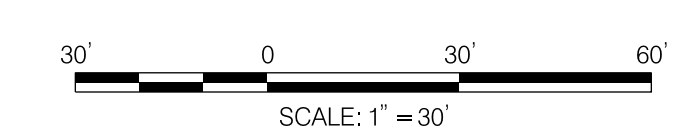

"PROFESSIONAL CERTIFICATION, I HEREBY CERTIFY THAT THESE DOCUMENTS WERE PREPARED OR APPROVED BY ME, AND THAT I AM A DULY LICENSED PROFESSIONAL ENGINEER UNDER THE LAWS OF THE STATE OF MARYLAND, LICENSE NO. _____, EXPIRATION DATE: _____"

DEPARTMENT OF PUBLIC WORKS
 HOWARD COUNTY, MARYLAND.

DIRECTOR OF PUBLIC WORKS _____ DATE _____ CHIEF, BUREAU OF HIGHWAYS _____ DATE _____

CHIEF, BUREAU OF ENGINEERING _____ DATE _____ CHIEF, TRANSPORTATION & SPECIAL PROJECTS DIV. _____ DATE _____

PREPARED BY:

Whitman, Requardt & Associates, LLP
 801 South Caroline Street, Baltimore, Maryland 21231

DES: SEP					
DRN: SRS					
CHK: BRT					
DATE: 06/2020	BY	NO.	REVISION	DATE	

ROADWAY PLAN

ADC MAP NO. 4933 GRID NO. K7

CAPITAL PROJECT CONTRACT NO. D7108

CLARKSVILLE - RIVER HILL STREETScape IMPROVEMENTS

PRELIMINARY SUBMITTAL (30%)

ELECTION DISTRICT 4/5 HOWARD COUNTY, MARYLAND

DWG. PS 01

SCALE 1" = 30'

SHEET 10 OF 45

N:\2020-021\CADD\PHD-P01_32020201.dgn June 26, 2020

STRUCTURE SCHEDULE						
NO.	STATION	OFFSET	BASELINE	MD STANDARD NO., TYPE	EL.	REMARKS
I-9	108+24	21' LT.	MD 108 WB	MD-374.66 PRECAST OR CAST IN PLACE SHALLOW COG INLET	TBD	10' CURB OPENING
I-10	113+93	37' RT.	MD 108 WB	MD-374.70 PRECAST STANDARD TYPE S INLET DOUBLE GRATE TANDEM	TBD	CURVED-VANE GRATE
I-11	114+62	23' LT.	MD 108 WB	MD-374.66 PRECAST OR CAST IN PLACE SHALLOW COG INLET	TBD	5' CURB OPENING
MH-3	115+08	30' LT.	MD 108 WB	MD-384.01 48" DIAMETER PRECAST MANHOLE FOR 12" TO 24" PIPES	TBD	.
S-3	108+20	60' LT.	MD 108 WB	MD-378.11 PRECAST STANDARD DOUBLE OPENING TYPE K INLET OPEN-END GRATE	TBD	NO OPENING

STRUCTURE SCHEDULE						
NO.	STATION	OFFSET	BASELINE	MD STANDARD NO., TYPE	EL.	REMARKS
S-4	114+78	68' LT.	MD 108 WB	MD-378.11 PRECAST STANDARD DOUBLE OPENING TYPE K INLET OPEN-END GRATE	TBD	.
EW-1	114+95	74' LT.	MD 108 WB	MD-368.01 STANDARD CONCRETE END SECTION ROUND CONCRETE PIPE	TBD	15" PIPE
ES-3	108+25	45' LT.	MD 108 WB	MD-368.01 STANDARD CONCRETE END SECTION ROUND CONCRETE PIPE	TBD	15" PIPE
ES-4	114+62	48' LT.	MD 108 WB	MD-368.01 STANDARD CONCRETE END SECTION ROUND CONCRETE PIPE	TBD	15" PIPE
C-3	114+95	45' RT.	MD 108 WB	PIPE CONNECTION	NA	15" PIPE
C-4	115+07	37' LT	MD 108 WB	PIPE CONNECTION	NA	18" PIPE TO PIPE

PIPE SCHEDULE							
FROM	TO	SIZE	TYPE	LENGTH	INV. IN	INV. OUT	REMARKS
I-9	ES-3	15"	RCP, CLASS IV	21'	TBD	TBD	.
I-10	C-3	15"	RCP, CLASS IV	100'	TBD	TBD	.
I-11	ES-4	15"	RCP, CLASS IV	22'	TBD	TBD	.
S-4	EW-1	15"	RCP, CLASS IV	18'	TBD	TBD	.
MH-3	C-4	18"	RCP, CLASS IV	6'	TBD	TBD	.

CURVE DATA						
CURVE	DELTA	Dc	R	L	T	E
MD108 WB-1	32° 02' 18.57" RT	41° 49' 18.25"	137.00'	76.61'	39.33'	5.53'
MD108 WB-2	2° 07' 23.10" LT	1° 30' 28.02"	3800.00'	140.81'	70.41'	0.65'
MD108 WB-3	2° 07' 23.93" RT	1° 05' 43.88"	5230.00'	193.82'	96.92'	0.90'
MD108 EB-1	30° 42' 43.30" RT	17° 21' 44.49"	330.00'	176.89'	90.63'	12.22'
MD108 EB-2	2° 43' 09.14" RT	1° 31' 11.22"	3770.00'	178.92'	89.48'	1.06'
MD108 EB-3	1° 23' 33.02" LT	1° 04' 51.79"	5300.00'	128.81'	64.41'	0.39'
PATH10-1	6° 54' 43.55" LT	28° 05' 10.20"	204.00'	24.61'	12.32'	0.37'
PATH10-2	4° 45' 44.45" RT	29° 22' 56.82"	195.00'	16.21'	8.11'	0.17'
PATH10-3	28° 11' 45.21" LT	67° 24' 24.48"	85.00'	41.83'	21.35'	2.64'
PATH10-4	24° 23' 11.00" RT	163° 42' 08.02"	35.00'	14.90'	7.56'	0.81'
PATH30-1	27° 36' 59.00" LT	67° 24' 24.48"	85.00'	40.97'	20.89'	2.53'
PATH30-2	19° 32' 54.86" RT	81° 51' 04.01"	70.00'	23.88'	12.06'	1.03'
PATH30-3	39° 41' 59.96" RT	163° 42' 08.02"	35.00'	24.25'	12.64'	2.21'

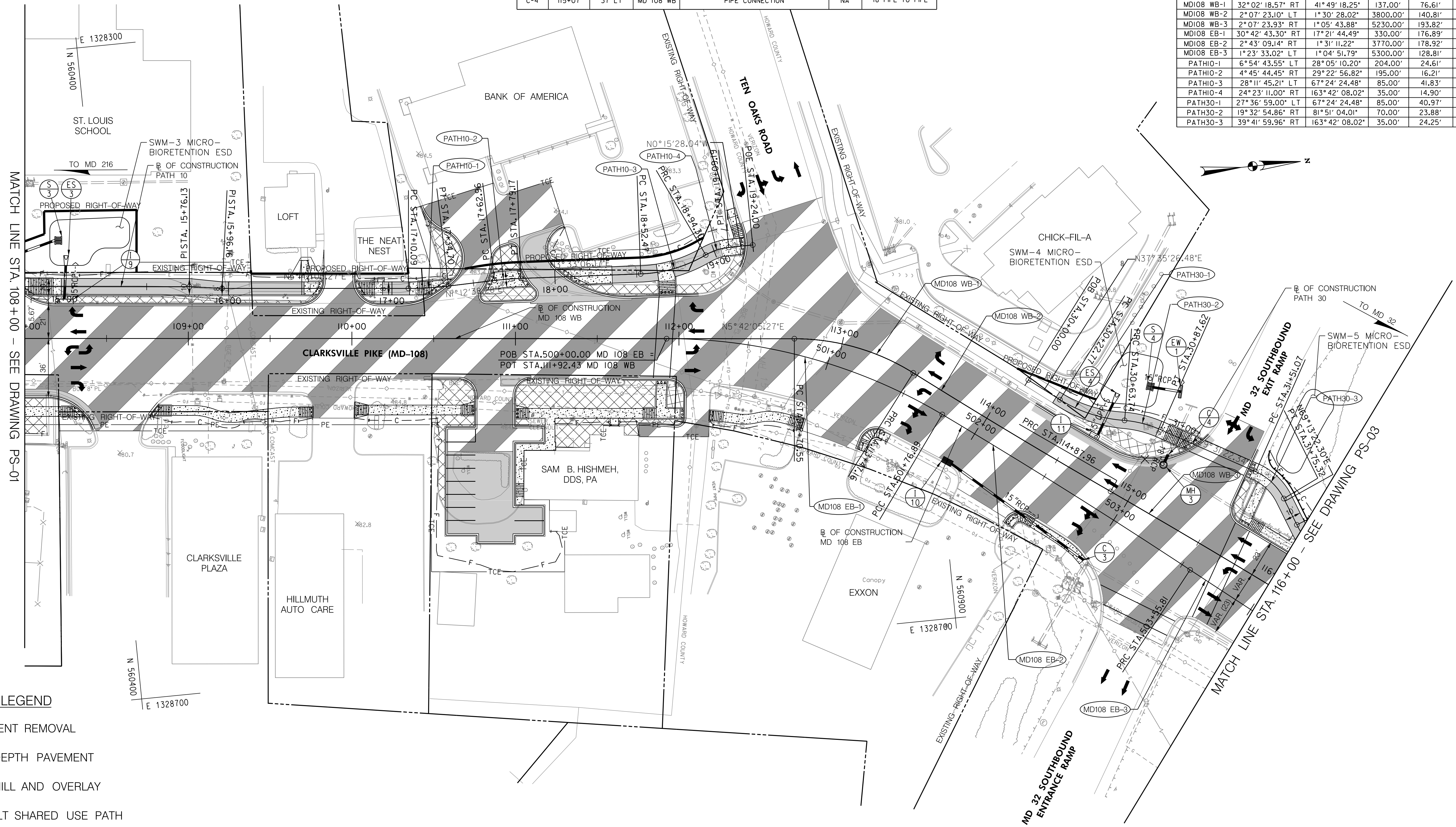

PAVEMENT LEGEND

- PAVEMENT REMOVAL
- FULL DEPTH PAVEMENT
- FINE MILL AND OVERLAY
- ASPHALT SHARED USE PATH
- CONCRETE SIDEWALK

"PROFESSIONAL CERTIFICATION, I HEREBY CERTIFY THAT THESE DOCUMENTS WERE PREPARED OR APPROVED BY ME, AND THAT I AM A DULY LICENSED PROFESSIONAL ENGINEER UNDER THE LAWS OF THE STATE OF MARYLAND, LICENSE NO. _____, EXPIRATION DATE: _____"

DEPARTMENT OF PUBLIC WORKS
HOWARD COUNTY, MARYLAND.

PREPARED BY:

Whitman, Reardon & Associates, LLP
801 South Carolina Street, Baltimore, Maryland 21231

DES: SEP			
DRN: SRS			
CHK: BRT			
DATE: 06/2020	BY	NO.	REVISION

ROADWAY PLAN

CAPITAL PROJECT CONTRACT NO. D7108
CLARKVILLE - RIVER HILL STREETScape IMPROVEMENTS
PRELIMINARY SUBMITTAL (30%)
ELECTION DISTRICT 4/5 HOWARD COUNTY, MARYLAND

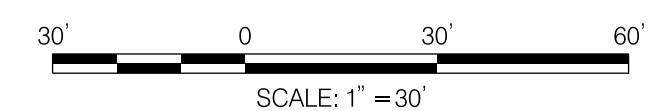

DWG.
PS 02
SCALE
1" = 30'
SHEET
11 of 45

N:\2020-021\CADD\PHD-P002_30202021.dgn
June 26, 2020

STRUCTURE SCHEDULE						
NO.	STATION	OFFSET	BASELINE	MD STANDARD NO., TYPE	EL.	REMARKS
I-12	I16+28	23' LT.	MD 108 WB	MD-374.62 PRECAST OR CAST IN PLACE CIRCULAR COG INLET FOR 8" CURB	TBD	15' CURB OPENING
I-13	I22+25	23' LT.	MD 108 WB	MD-374.62 PRECAST OR CAST IN PLACE CIRCULAR COG INLET FOR 8" CURB	TBD	15' CURB OPENING
MH-4	I16+25	28' LT.	MD 108 WB	MD-384.01 48" DIAMETER PRECAST MANHOLE FOR 12' TO 24" PIPES	TBD	.
MH-5	I23+08	40' LT.	MD 108	MD-384.01 48" DIAMETER PRECAST MANHOLE FOR 12' TO 24" PIPES	TBD	.

PIPE SCHEDULE							
FROM	TO	SIZE	TYPE	LENGTH	INV. IN	INV. OUT	REMARKS
I-12	MH-4	15'	RCP, CLASS IV	2'	TBD	TBD	.
I-13	MH-5	15'	RCP, CLASS IV	80'	TBD	TBD	.

CURVE DATA						
CURVE	DELTA	Dc	R	L	T	E
MD108 WB-3	2°07' 23.93" RT	1°05' 43.88"	5230.00'	193.82'	96.92'	0.90'
MD108 WB-4	5°08' 56.42" RT	1°06' 35.83"	5162.00'	463.89'	232.10'	5.22'
MD108 WB-5	0°14' 48.64" LT	1°04' 51.79"	5300.00'	22.83'	11.42'	0.01'
MD108 EB-3	1°23' 33.02" LT	1°04' 51.79"	5300.00'	128.81'	64.41'	0.39'
MD108 EB-4	4°54' 07.78" RT	1°31' 11.22"	3770.00'	322.56'	161.38'	3.45'
MD108-1	4°10' 17.57" LT	1°04' 47.75"	5305.00'	386.28'	193.22'	3.52'
PATH30-4	31°28' 57.63" LT	81°51' 04.01"	70.00'	38.46'	19.73'	2.73'
PATH30-5	13°40' 38.85" RT	54°34' 02.67"	105.00'	25.07'	12.59'	0.75'
PATH30-6	10°05' 19.54" LT	60°18' 40.85"	95.00'	16.73'	8.39'	0.37'
PATH30-7	1°33' 37.11" RT	1°04' 27.22"	5333.67'	145.25'	72.63'	0.49'
PATH30-8	1°40' 45.18" LT	1°05' 16.67"	5266.33'	154.34'	77.18'	0.57'

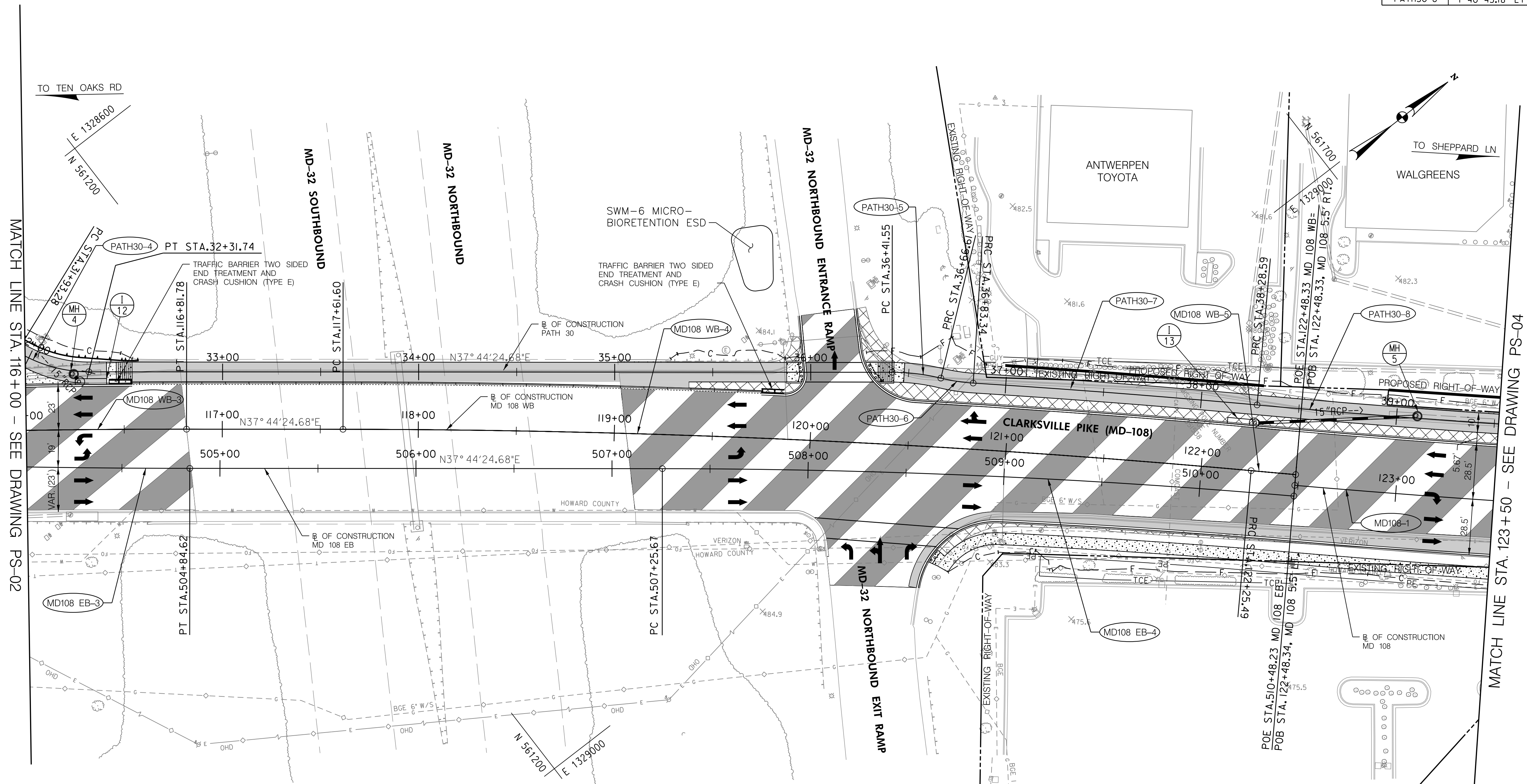

PAVEMENT LEGEND

- PAVEMENT REMOVAL
- FULL DEPTH PAVEMENT
- FINE MILL AND OVERLAY
- ASPHALT SHARED USE PATH
- CONCRETE SIDEWALK

"PROFESSIONAL CERTIFICATION, I HEREBY CERTIFY THAT THESE DOCUMENTS WERE PREPARED OR APPROVED BY ME, AND THAT I AM A DULY LICENSED PROFESSIONAL ENGINEER UNDER THE LAWS OF THE STATE OF MARYLAND, LICENSE NO. _____, EXPIRATION DATE: _____."

DEPARTMENT OF PUBLIC WORKS
HOWARD COUNTY, MARYLAND.

PREPARED BY :



Whitman, Requardt & Associates, LLP
801 South Caroline Street, Baltimore, Maryland 21231

DES: SEP					
DRN: SRS					
CHK: BRT					
DATE: 06/2020	BY	NO.	REVISION	DATE	

ROADWAY PLAN

ADC MAP NO. 4933 GRID NO. K7

CAPITAL PROJECT CONTRACT NO. D7108

CLARKVILLE - RIVER HILL STREETScape IMPROVEMENTS

PRELIMINARY SUBMITTAL (30%)

ELECTION DISTRICT 4/5

HOWARD COUNTY, MARYLAND

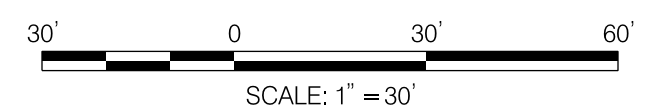

DWG.
PS 03

SCALE
1" = 30'

SHEET
12 of 45

STRUCTURE SCHEDULE						
NO.	STATION	OFFSET	BASELINE	MD STANDARD NO., TYPE	EL.	REMARKS
I-14	I23+70	29' LT.	MD 108	MD-374.63 PRECAST OR CAST IN PLACE CIRCULAR COS INLET	TBD	20' CURB OPENING
I-15	I23+71	29' RT.	MD 108	MD-374.63 PRECAST OR CAST IN PLACE CIRCULAR COS INLET	TBD	15' CURB OPENING
I-16	I25+29	29' RT.	MD 108	MD-374.62 PRECAST OR CAST IN PLACE CIRCULAR COG INLET	TBD	20' CURB OPENING
I-17	I23+00	29' RT.	MD 108	MD-374.66 PRECAST OR CAST IN PLACE SHALLOW COG INLET	TBD	5' CURB OPENING
I-18	I32+38	29' RT.	MD 108	MD-374.66 PRECAST OR CAST IN PLACE SHALLOW COG INLET	TBD	5' CURB OPENING
MH-6	I23+70	41' LT.	MD 108	MD-384.01 48" DIAMETER PRECAST MANHOLE FOR 12" TO 24" PIPES	TBD	.
MH-7	I23+69	23' RT.	MD 108	MD-384.01 48" DIAMETER PRECAST MANHOLE FOR 12" TO 24" PIPES	TBD	.
MH-8	I25+23	39' LT.	MD 108	MD-384.01 48" DIAMETER PRECAST MANHOLE FOR 12" TO 24" PIPES	TBD	.

STRUCTURE SCHEDULE						
NO.	STATION	OFFSET	BASELINE	MD STANDARD NO., TYPE	EL.	REMARKS
MH-9	601+97	31' RT.	GREAT STAR DR.	MD-384.01 48" DIAMETER PRECAST MANHOLE FOR 12" TO 24" PIPES	TBD	.
S-5	I30+49	60' RT.	MD 108	MD-378.11 PRECAST STANDARD DOUBLE OPENING TYPE K INLET OPEN-END GRATE	TBD	.
S-6	601+98	50' RT.	GREAT STAR DR.	MD-378.11 PRECAST STANDARD DOUBLE OPENING TYPE K INLET OPEN-END GRATE	TBD	.
S-7	I32+22	63' RT.	MD 108	MD-378.11 PRECAST STANDARD DOUBLE OPENING TYPE K INLET OPEN-END GRATE	TBD	.
ES-5	I30+07	45' RT.	MD 108	MD-368.01 STANDARD CONCRETE END SECTION ROUND CONCRETE PIPE	TBD	15" PIPE
ES-6	I32+38	50' RT.	MD 108	MD-368.01 STANDARD CONCRETE END SECTION ROUND CONCRETE PIPE	TBD	15" PIPE
C-5	600+97	33' RT.	MD 108	PIPE CONNECTION	NA	15" PIPE
C-6	601+17	58' LT.	MD 108	PIPE CONNECTION	NA	15" PIPE

PIPE SCHEDULE							
FROM	TO	SIZE	TYPE	LENGTH	INV. IN	INV. OUT	REMARKS
I-16	MH-8	15"	RCP, CLASS IV	8'	TBD	TBD	.
I-17	ES-5	15"	RCP, CLASS IV	16'	TBD	TBD	.
S-5	C-5	15"	RCP, CLASS IV	61'	TBD	TBD	.
S-6	MH-9	15"	RCP, CLASS IV	15'	TBD	TBD	.
S-7	C-6	15"	RCP, CLASS IV	63'	TBD	TBD	.
I-18	ES-6	15"	RCP, CLASS IV	19'	TBD	TBD	.

LIMIT OF WORK
 T7108
 CLARKSVILLE PIKE
 STA. 132+07

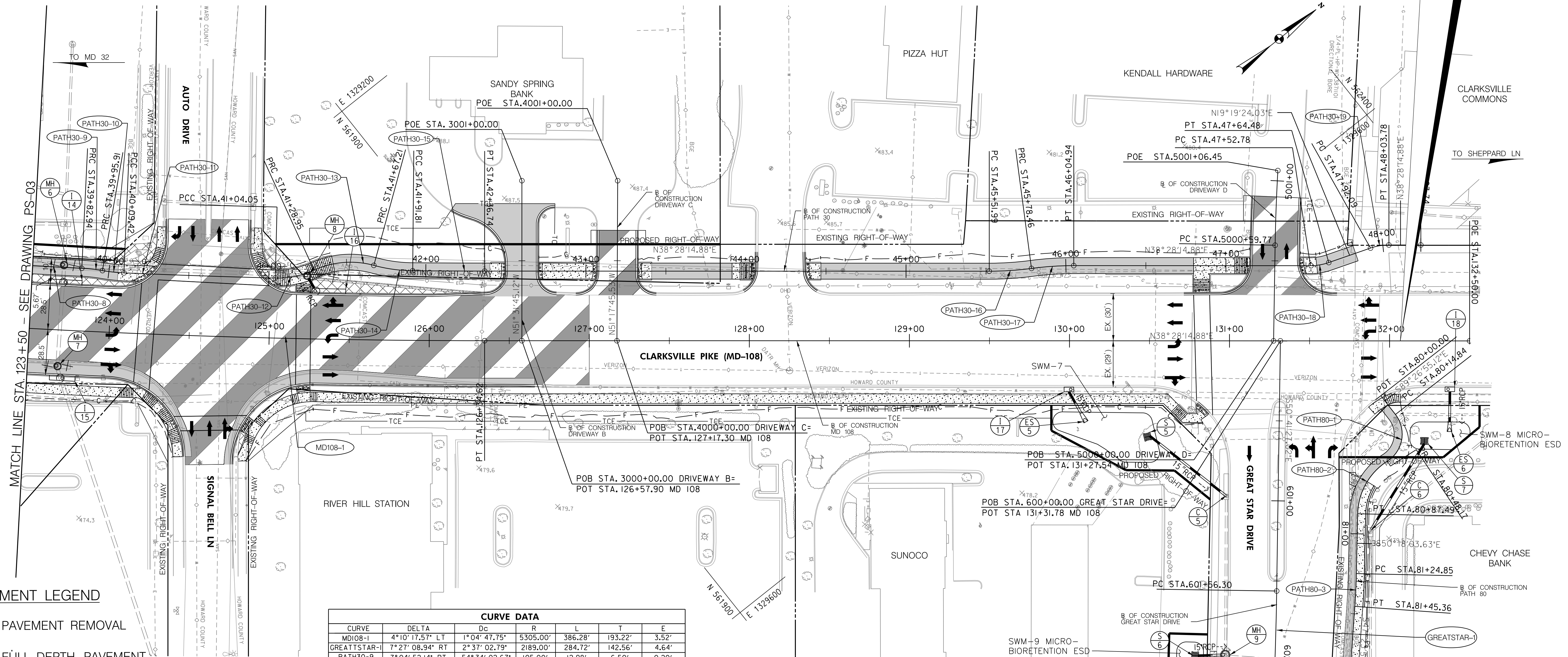

PAVEMENT LEGEND

[Symbol]	PAVEMENT REMOVAL
[Symbol]	FULL DEPTH PAVEMENT
[Symbol]	FINE MILL AND OVERLAY
[Symbol]	ASPHALT SHARED USE PATH
[Symbol]	CONCRETE SIDEWALK

CURVE DATA

CURVE	DELTA	Dc	R	L	T	E
MD108-1	4°10'17.57" LT	1°04'47.75"	5305.00'	386.28'	193.22'	3.52'
GREATSTAR-1	7°27'08.94" RT	2°37'02.79"	2189.00'	284.72'	142.56'	4.64'
PATH30-9	7°04'52.14" RT	54°34'02.67"	105.00'	12.98'	6.50'	0.20'
PATH30-10	7°22'06.37" LT	54°34'02.67"	105.00'	13.50'	6.76'	0.22'
PATH30-11	1°01'45.38" LT	1°05'15.43"	5268.00'	94.64'	47.32'	0.21'
PATH30-12	25°56'28.27" LT	104°10'26.92"	55.00'	24.90'	12.67'	1.44'
PATH30-13	39°50'56.95" RT	104°10'26.92"	55.00'	38.25'	19.94'	3.50'
PATH30-14	14°50'29.02" LT	60°18'40.85"	95.00'	24.61'	12.37'	0.80'
PATH30-15	0°29'21.08" LT	1°05'19.89"	5262.00'	44.93'	22.46'	0.05'
PATH30-16	7°35'06.20" LT	28°38'52.40"	200.00'	26.48'	13.26'	0.44'
PATH30-17	7°35'06.20" RT	28°38'52.40"	200.00'	26.48'	13.26'	0.44'
PATH30-18	19°08'50.85" LT	163°42'08.02"	35.00'	11.70'	5.90'	0.49'
PATH30-19	19°08'50.85" RT	163°42'08.02"	35.00'	11.70'	5.90'	0.49'
PATH80-1	95°28'14.89" RT	286°28'44.03"	20.00'	33.32'	22.01'	9.74'
PATH80-2	56°19'23.40" LT	143°14'22.02"	40.00'	39.32'	21.41'	5.37'
PATH80-3	2°54'07.70" RT	14°08'49.58"	405.00'	20.51'	10.26'	0.13'

"PROFESSIONAL CERTIFICATION, I HEREBY CERTIFY THAT THESE DOCUMENTS WERE PREPARED OR APPROVED BY ME, AND THAT I AM A DULY LICENSED PROFESSIONAL ENGINEER UNDER THE LAWS OF THE STATE OF MARYLAND, LICENSE NO. _____, EXPIRATION DATE: _____"

DEPARTMENT OF PUBLIC WORKS
 HOWARD COUNTY, MARYLAND.

DIRECTOR OF PUBLIC WORKS DATE CHIEF, BUREAU OF HIGHWAYS DATE
 CHIEF, BUREAU OF ENGINEERING DATE CHIEF, TRANSPORTATION & SPECIAL PROJECTS DIV. DATE

PREPARED BY:
WRA
 Whitman, Requardt & Associates, LLP
 801 South Caroline Street, Baltimore, Maryland 21231

DES: SEP			
DRN: SRS			
CHK: BRT			
DATE: 06/2020	BY NO.	REVISION	DATE

ROADWAY PLAN

ADC MAP NO. 4933 GRID NO. K7

CAPITAL PROJECT CONTRACT NO. D7108
 CLARKSVILLE - RIVER HILL STREETScape IMPROVEMENTS
 PRELIMINARY SUBMITTAL (30%)
 ELECTION DISTRICT 4/5 HOWARD COUNTY, MARYLAND

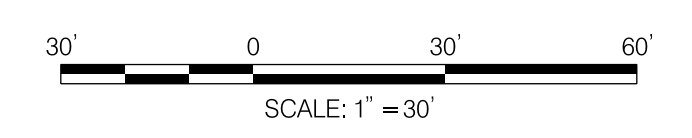

DWG. PS 04
 SCALE 1" = 30'
 SHEET 13 of 45



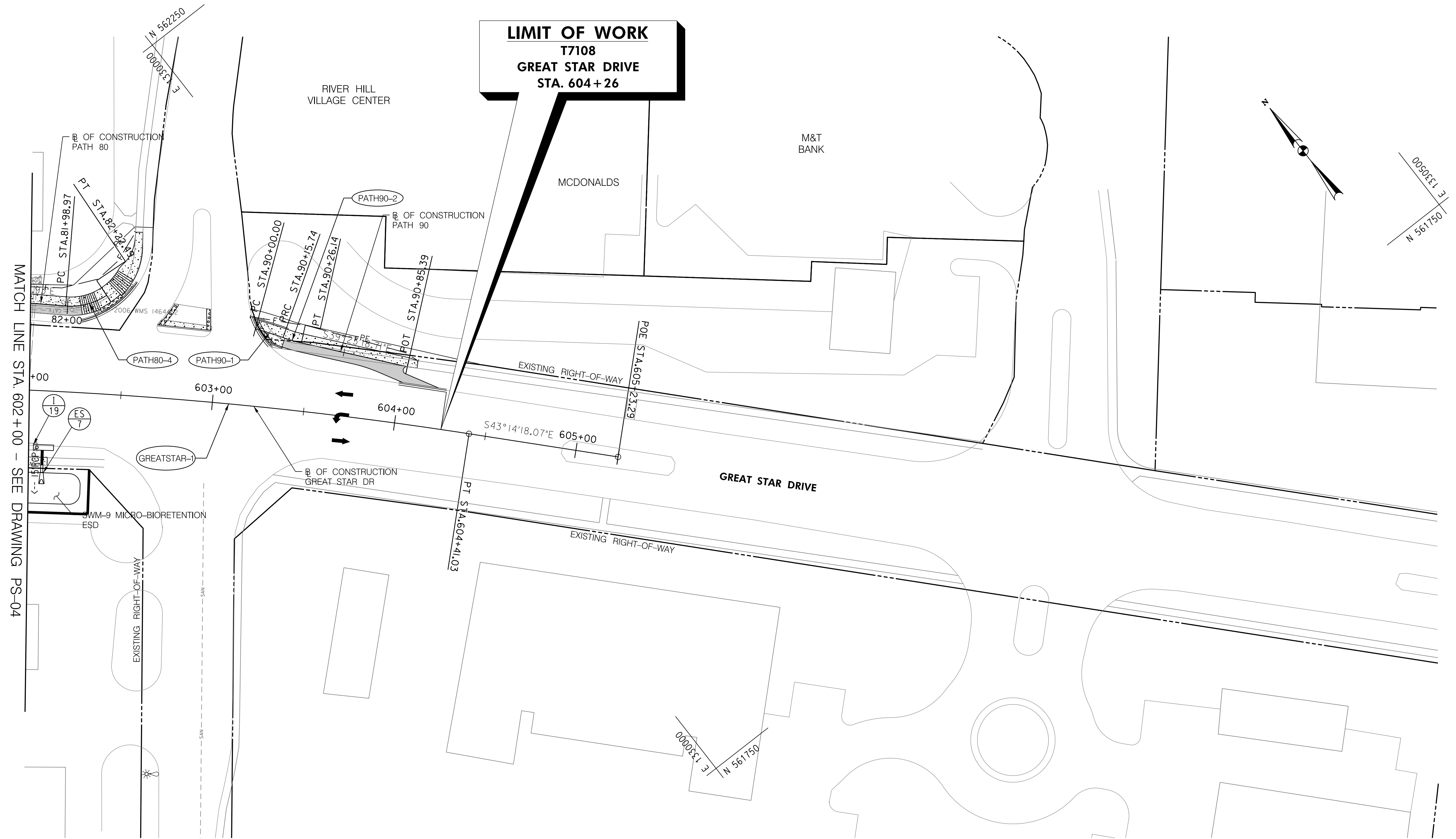

N:\2020-021\ADDP\PHD-P004_30202021.dgn
 June 26, 2020

STRUCTURE SCHEDULE						
NO.	STATION	OFFSET	BASELINE	MD STANDARD NO., TYPE	EL.	REMARKS
I-19	602+09	29' RT.	GREAT STAR DR.	MD-374.66 PRECAST OR CAST IN PLACE SHALLOW COG INLET	TBD	10' CURB OPENING
ES-7	602+09	45' RT.	GREAT STAR DR.	MD-368.01 STANDARD CONCRETE END SECTION ROUND CONCRETE PIPE	TBD	15' PIPE

PIPE SCHEDULE							
FROM	TO	SIZE	TYPE	LENGTH	INV. IN	INV. OUT	REMARKS
I-19	ES-7	15"	RCP, CLASS IV	13'	TBD	TBD	



PAVEMENT LEGEND

-  PAVEMENT REMOVAL
-  FULL DEPTH PAVEMENT
-  FINE MILL AND OVERLAY
-  ASPHALT SHARED USE PATH
-  CONCRETE SIDEWALK

CURVE DATA						
CURVE	DELTA	Dc	R	L	T	E
GREATSTAR-1	7° 27' 08.94" RT	2° 37' 02.79"	2189.00'	284.72'	142.56'	4.64'
PATH80-4	38° 30' 07.33" LT	163° 42' 08.02"	35.00'	23.52'	12.22'	2.07'
PATH90-1	4° 37' 28.77" RT	29° 22' 56.82"	195.00'	15.74'	7.87'	0.16'
PATH90-2	7° 00' 42.15" LT	67° 24' 24.48"	85.00'	10.40'	5.21'	0.16'

"PROFESSIONAL CERTIFICATION, I HEREBY CERTIFY THAT THESE DOCUMENTS WERE PREPARED OR APPROVED BY ME, AND THAT I AM A DULY LICENSED PROFESSIONAL ENGINEER UNDER THE LAWS OF THE STATE OF MARYLAND, LICENSE NO. _____, EXPIRATION DATE: _____."

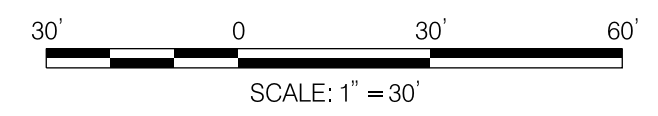

N:\3202-021\CADD\PHD-P005_3202021.dgn June 26, 2020

DEPARTMENT OF PUBLIC WORKS
HOWARD COUNTY, MARYLAND.

DIRECTOR OF PUBLIC WORKS _____ DATE _____
CHIEF, BUREAU OF HIGHWAYS _____ DATE _____

CHIEF, BUREAU OF ENGINEERING _____ DATE _____
CHIEF, TRANSPORTATION & SPECIAL PROJECTS DIV. _____ DATE _____

PREPARED BY:



Whitman, Reardon & Associates, LLP
201 South Caroline Street, Baltimore, Maryland 21231

DES: SEP					
DRN: SRS					
CHK: BRT					
DATE: 06/2020	BY	NO.	REVISION	DATE	

ROADWAY PLAN

ADC MAP NO. 4933 GRID NO. K7

CAPITAL PROJECT CONTRACT NO. D7108
CLARKVILLE - RIVER HILL STREETScape IMPROVEMENTS
PRELIMINARY SUBMITTAL (30%)
ELECTION DISTRICT 4/5 HOWARD COUNTY, MARYLAND

DWG. PS 05
SCALE 1" = 30'
SHEET 14 OF 45