

# Oakland Mills Road, Typical Road Cross-Sections Existing & Proposed [2 OPTIONS]

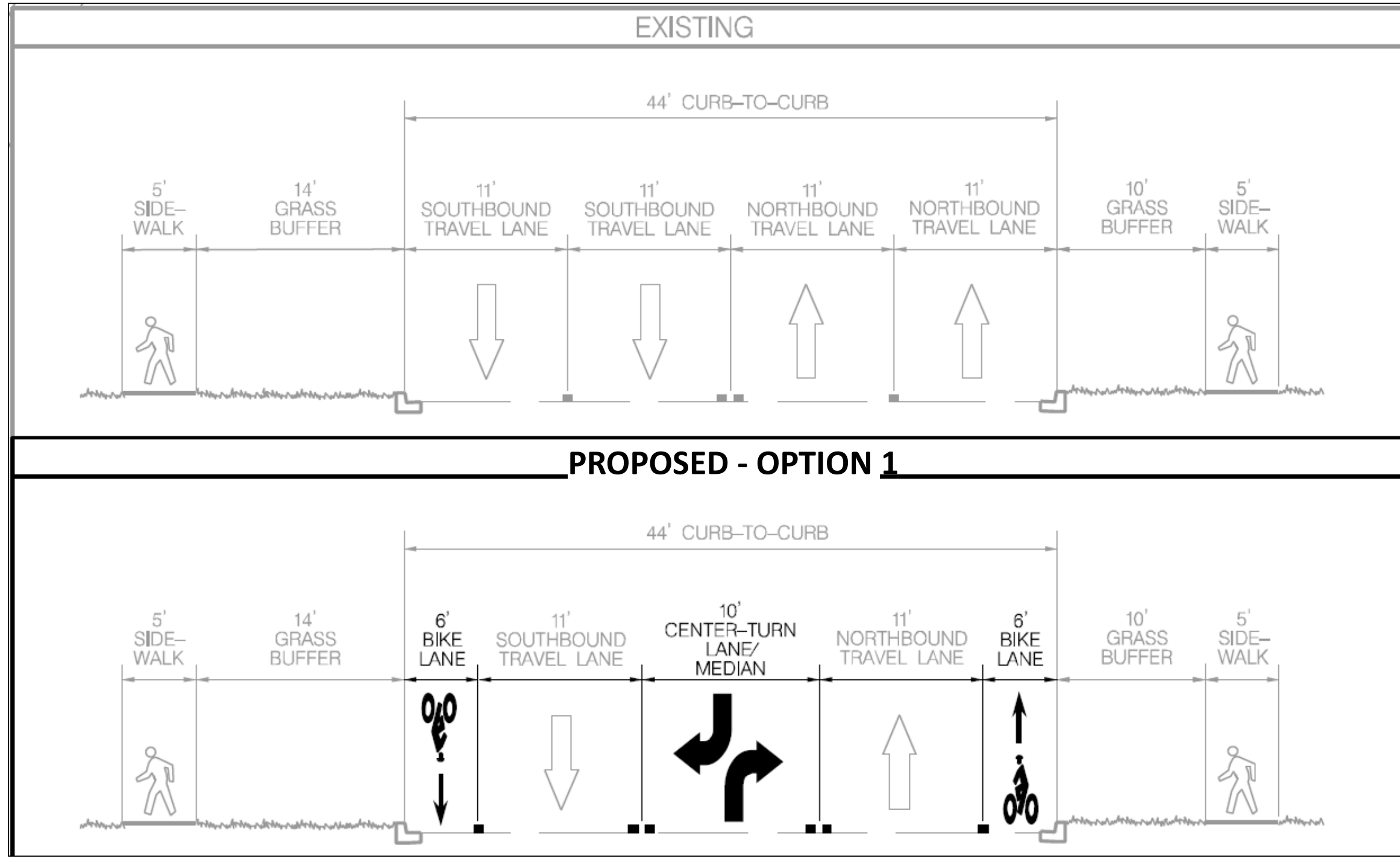

Rendering of Proposed OPTION 1 Typical Section

Existing and Proposed Typical Roadway Cross Section OPTION 1

**OPTION 1: Traditional Curbside Bike Lanes, with a center lane for all left turns**

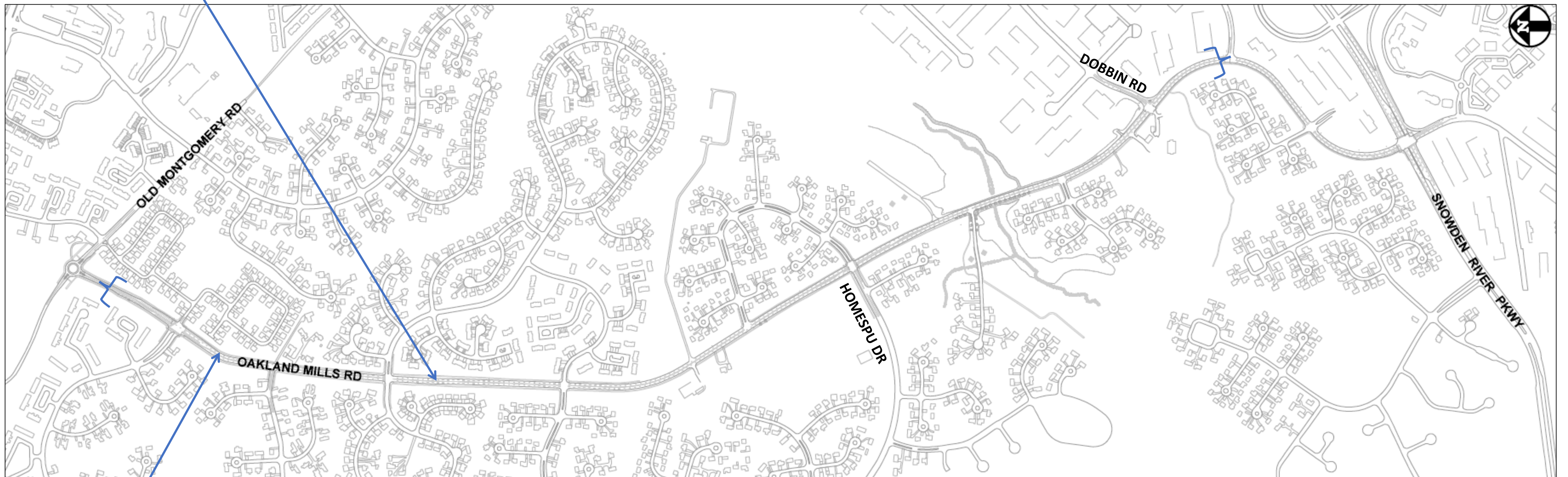

**OPTION 2: Two-way Bike Lanes on one side of Oakland Mills, with a center lane for all left turns**

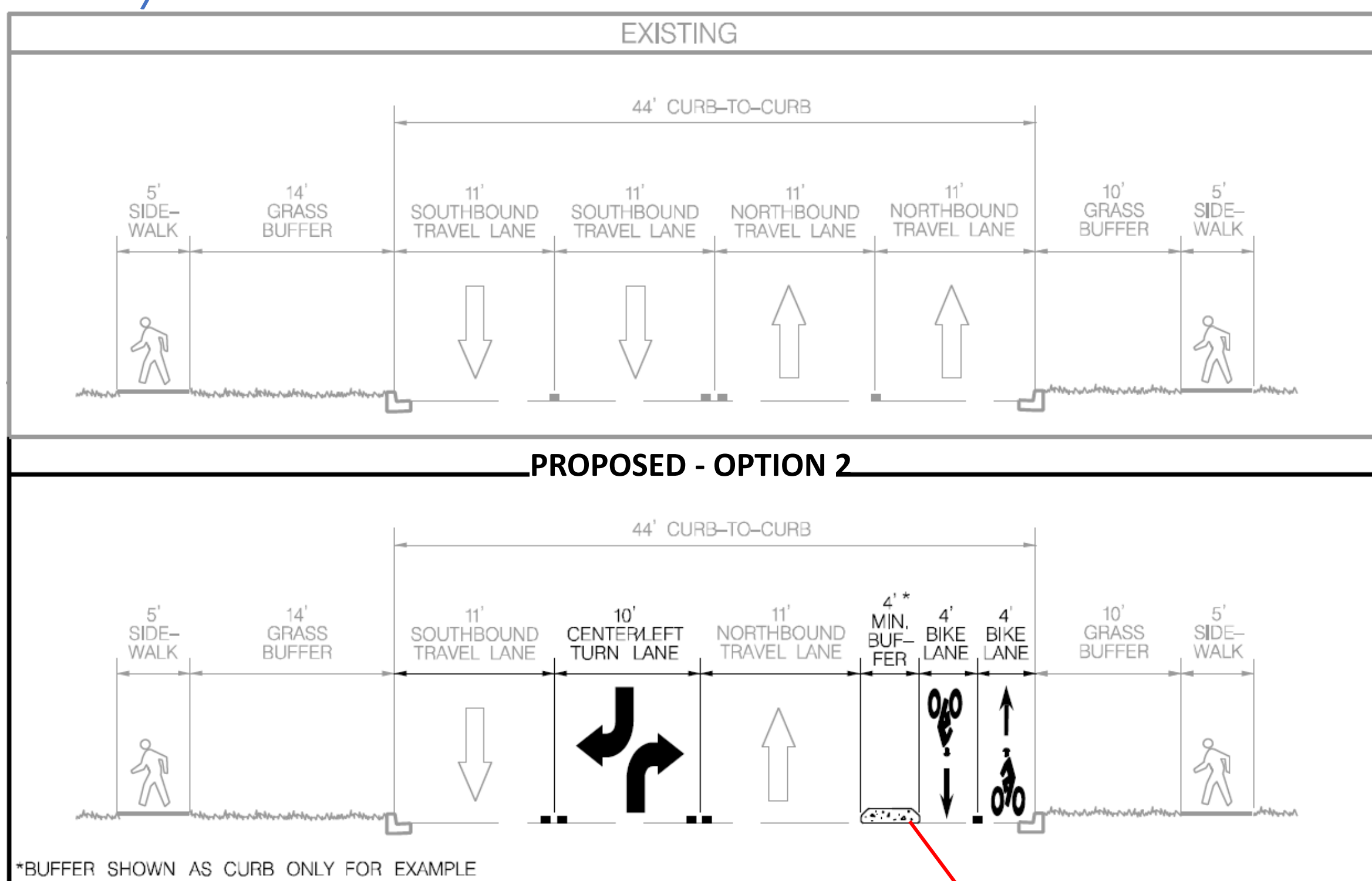

Rendering of Proposed OPTION 2 Typical Section

Existing and Proposed Typical Roadway Cross Section OPTION 2

**Buffer Shown as Concrete Curb for Rendering Purposes Only. Other Vertical Buffer Examples Include:**



Rubber Wheel Stops



Flexible Posts + Hatching



Posts + Delineators



Armadillos™

# Oakland Mills Road, How a Road Diet Looks at a Typical Signalized Intersection

## OPTION 1

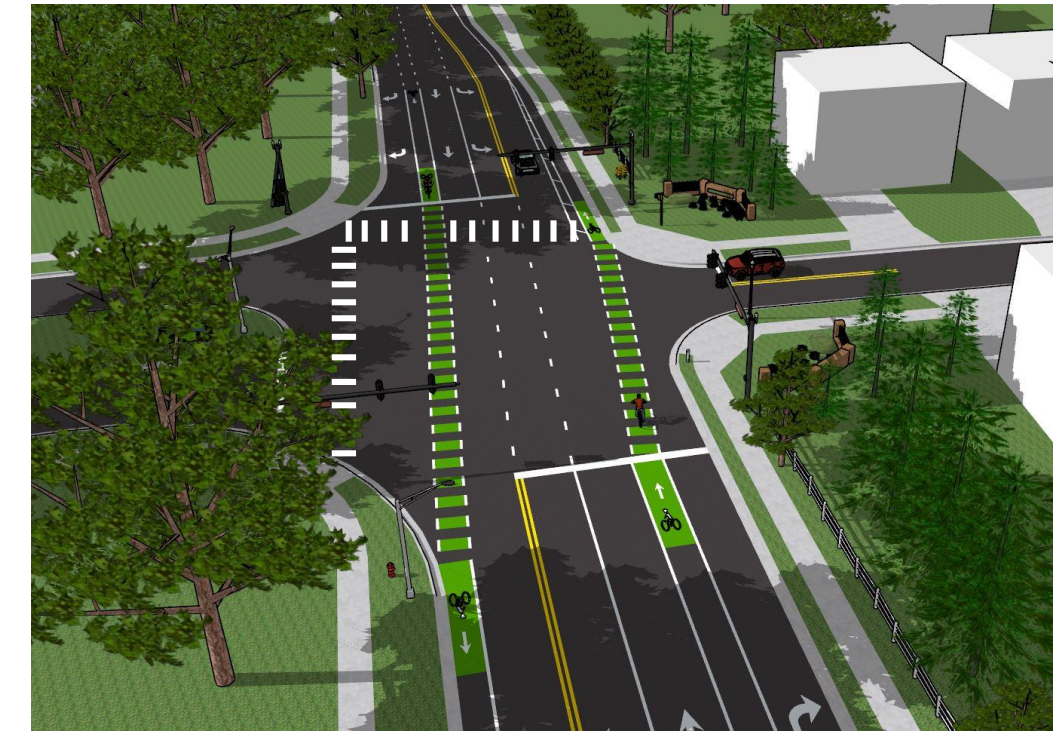
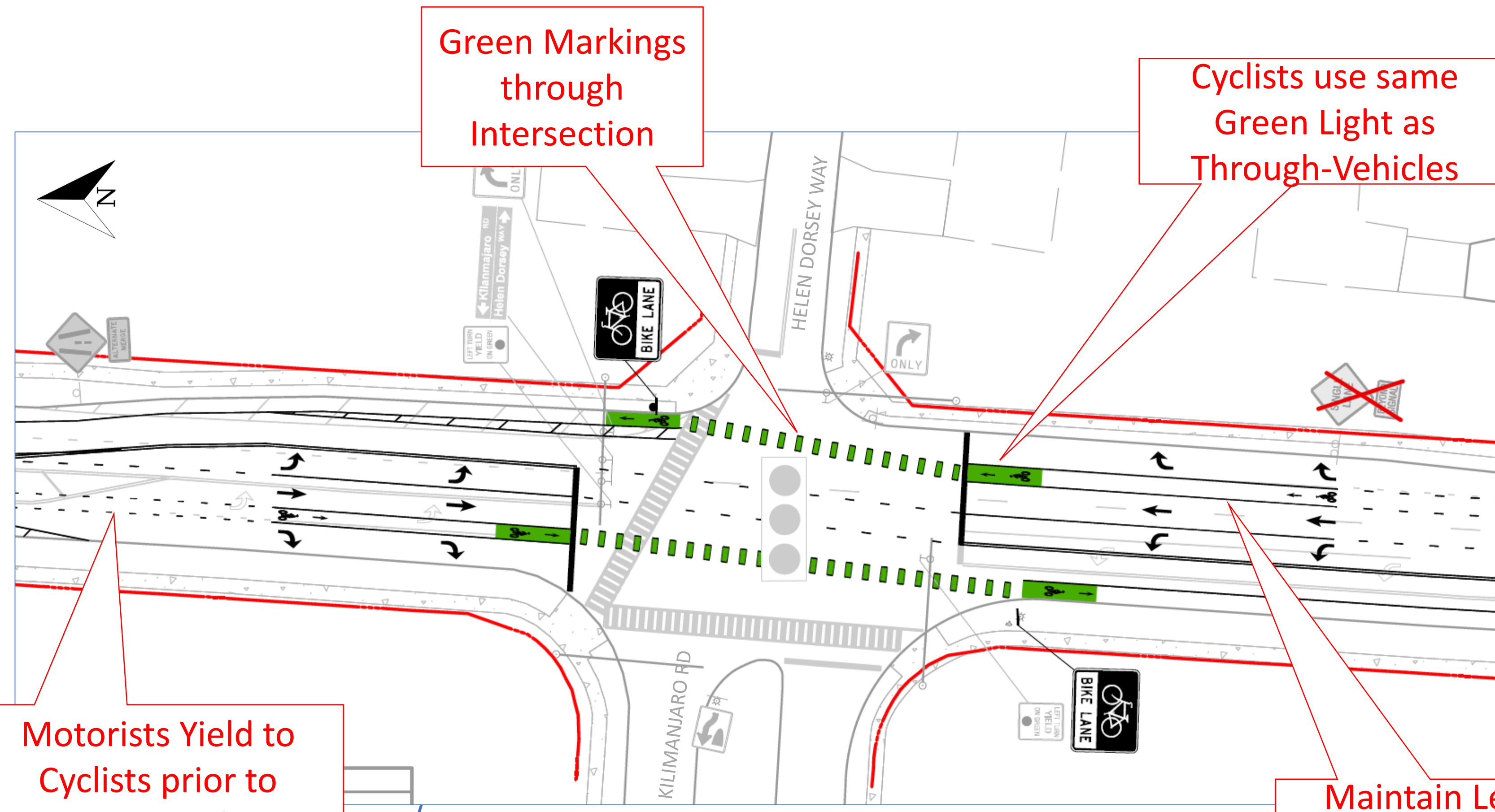

Intersection of Oakland Mills Rd at Kilimanjaro Rd, under OPTION 1 scenario.

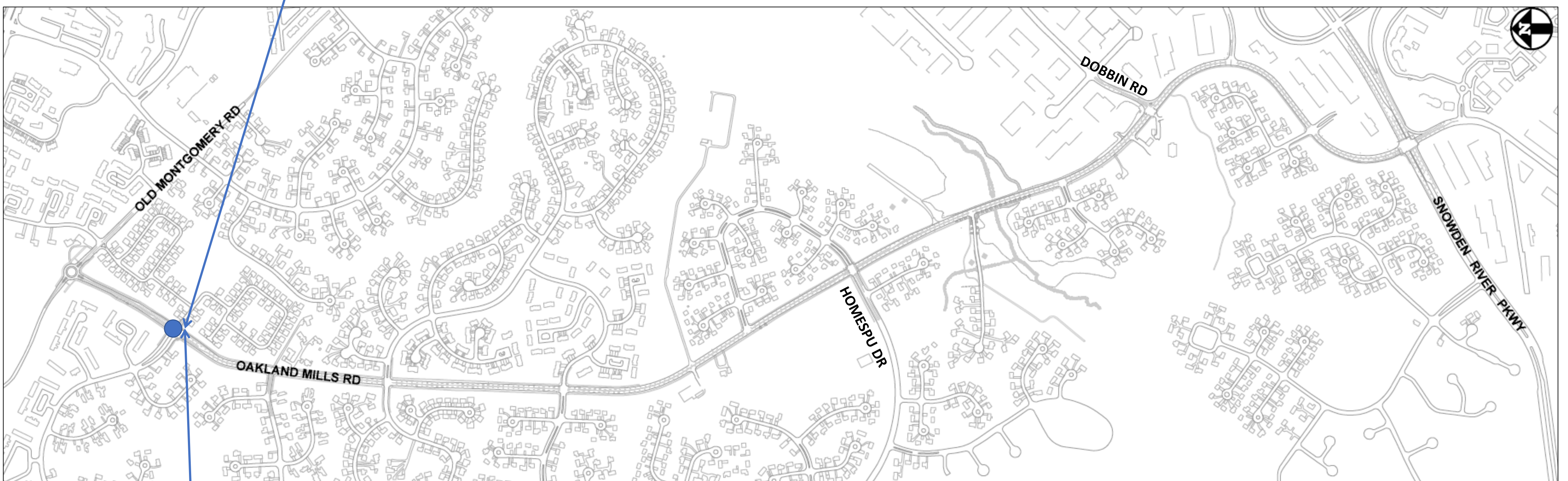

## OPTION 2

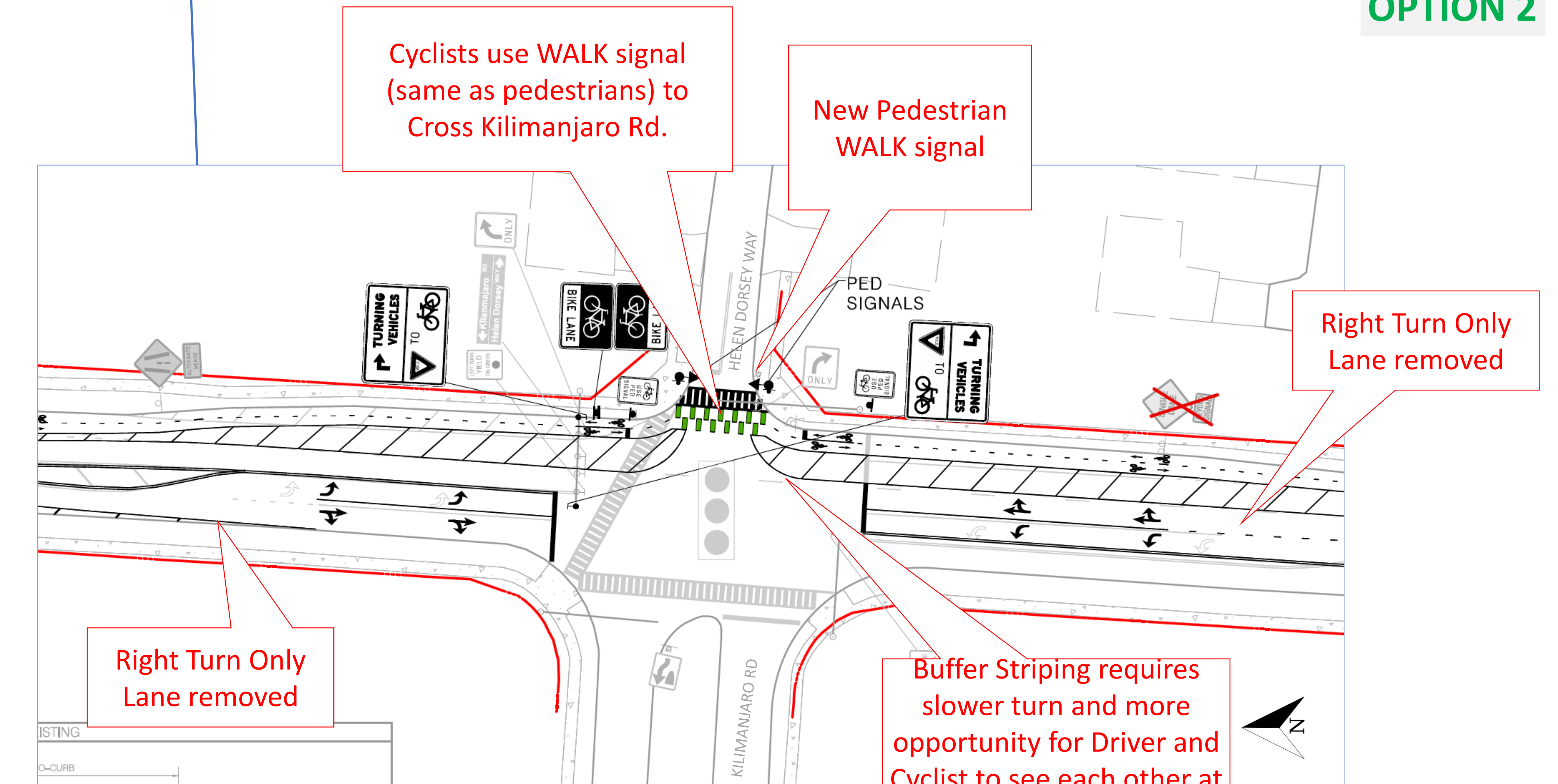

Intersection of Oakland Mills Rd at Kilimanjaro Rd, under OPTION 2 scenario.

# Oakland Mills Road, 4 New Pedestrian Crossings

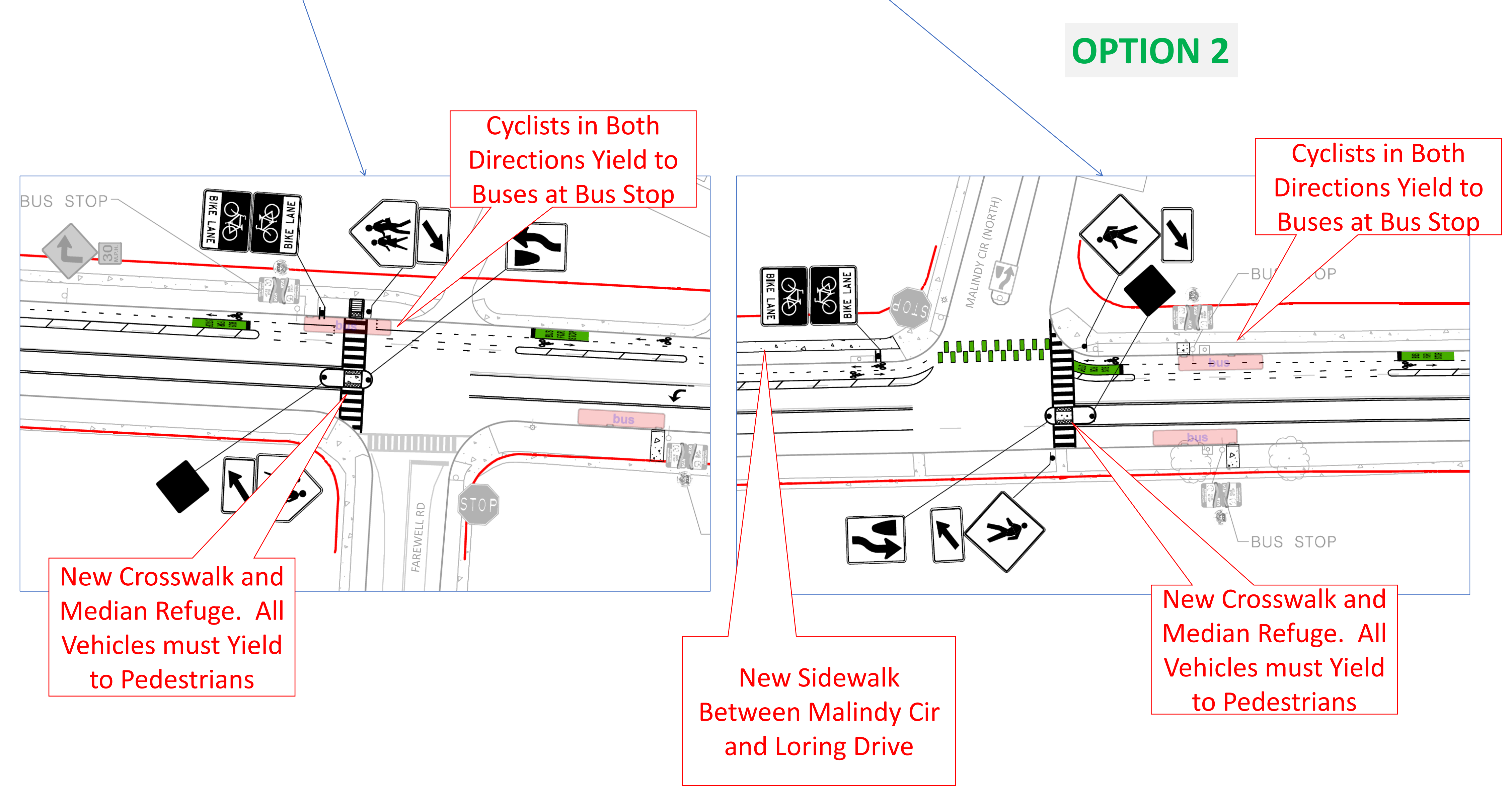
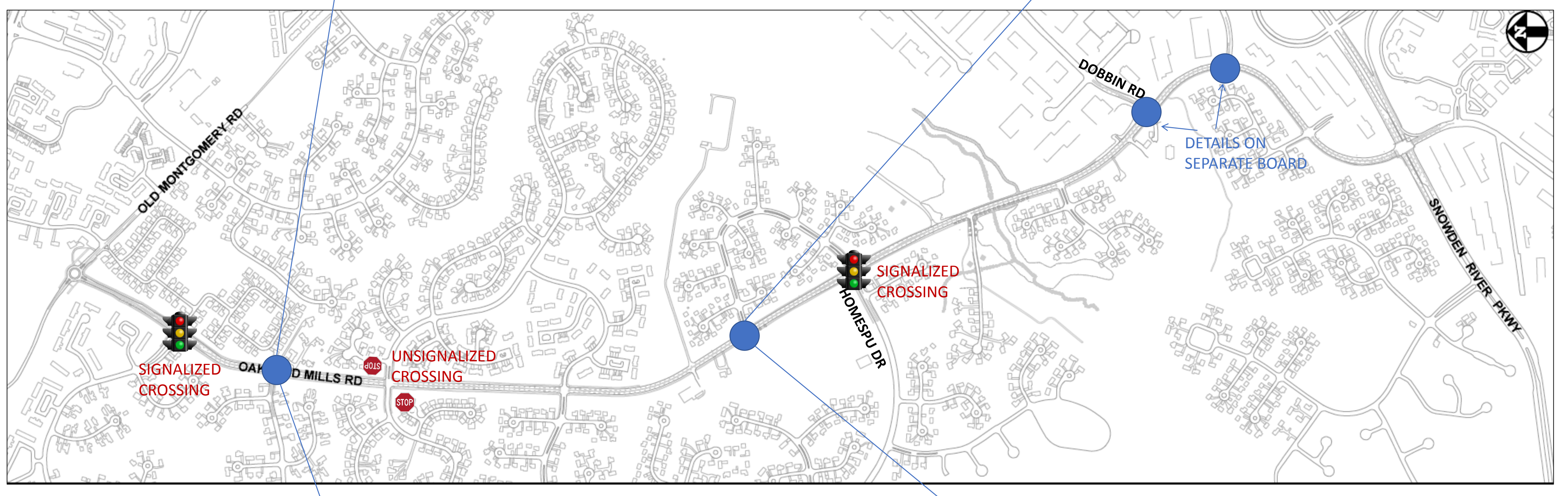
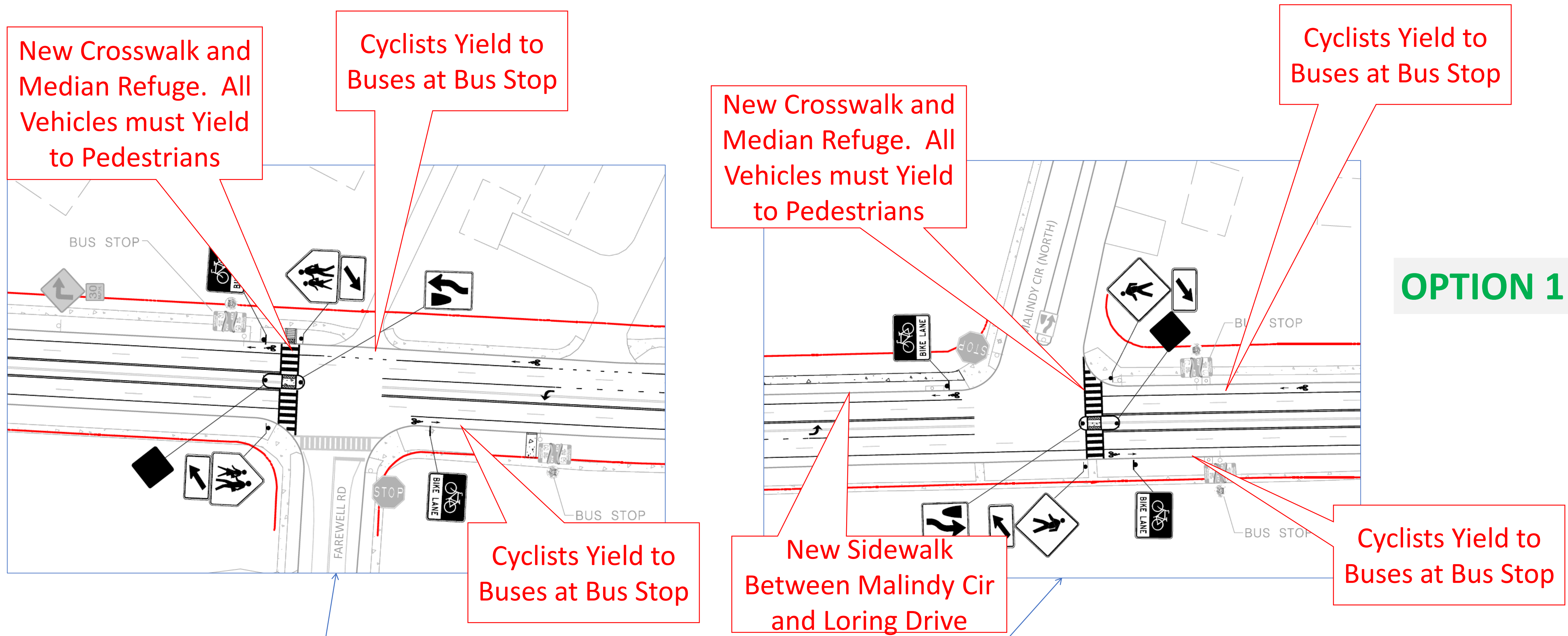

# Oakland Mills Road, from Dobbin Road to Oak Hall Lane

## OPTION 1

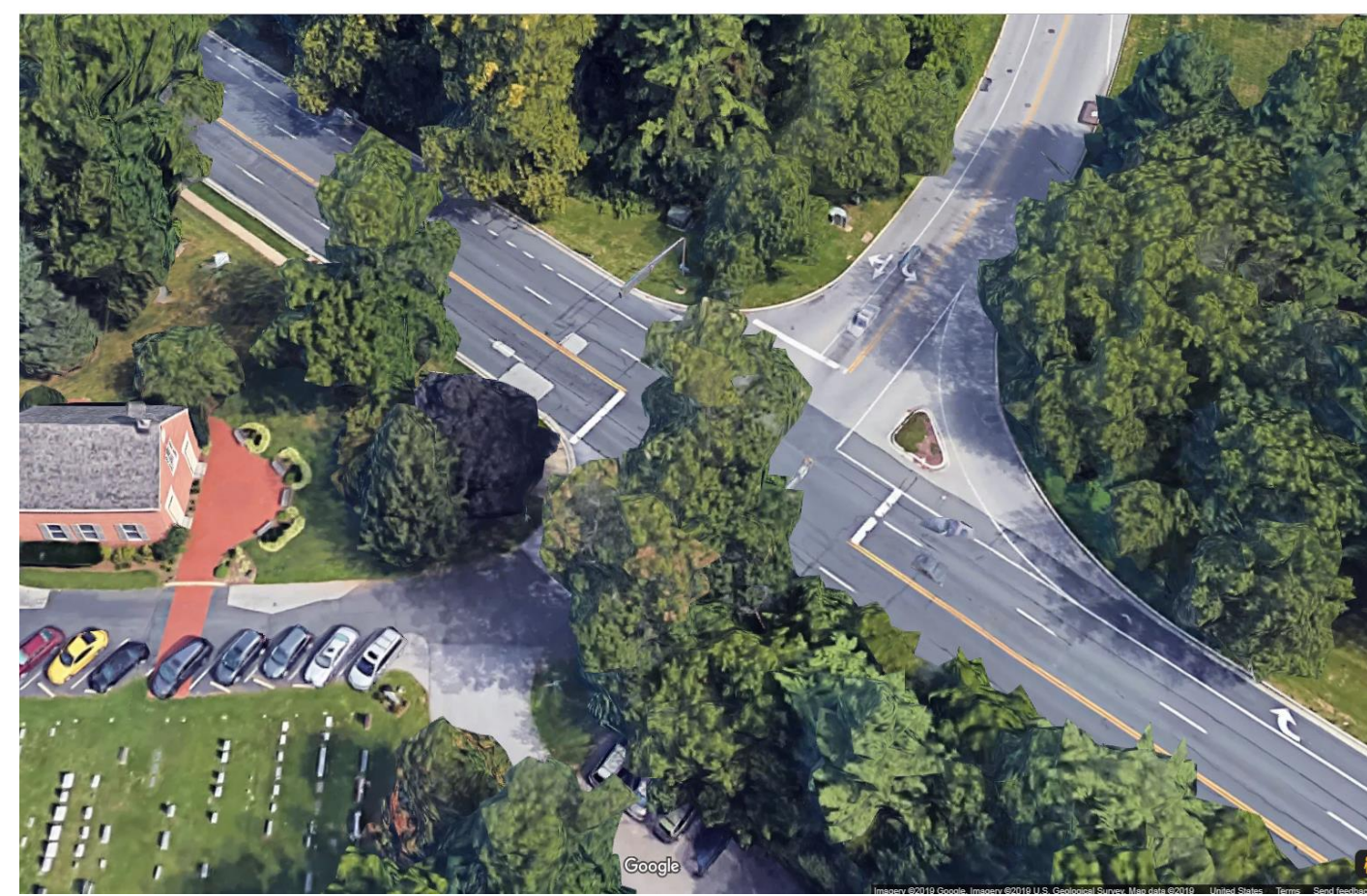
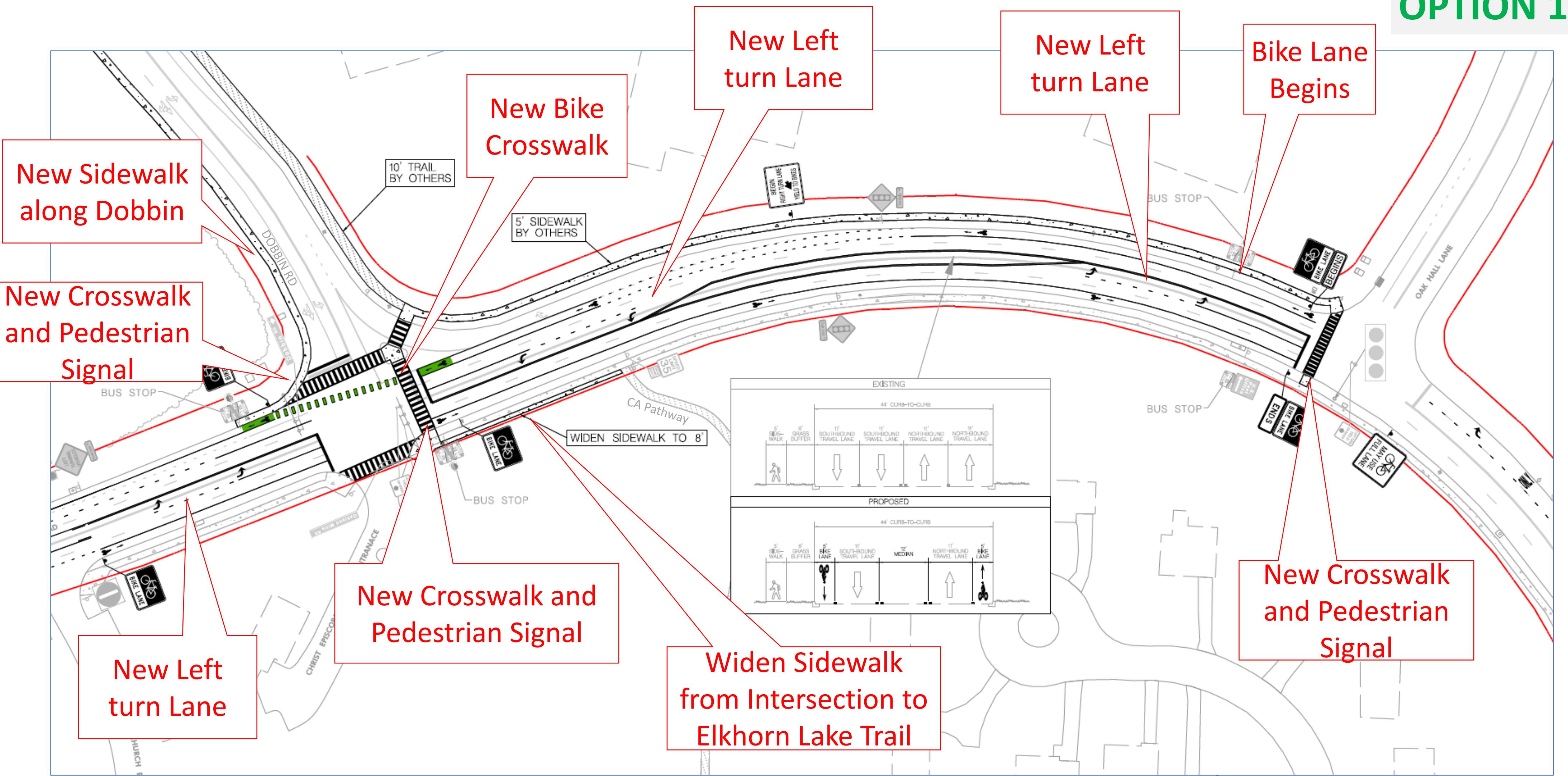

Intersection of Dobbin Road and Oakland Mills Road

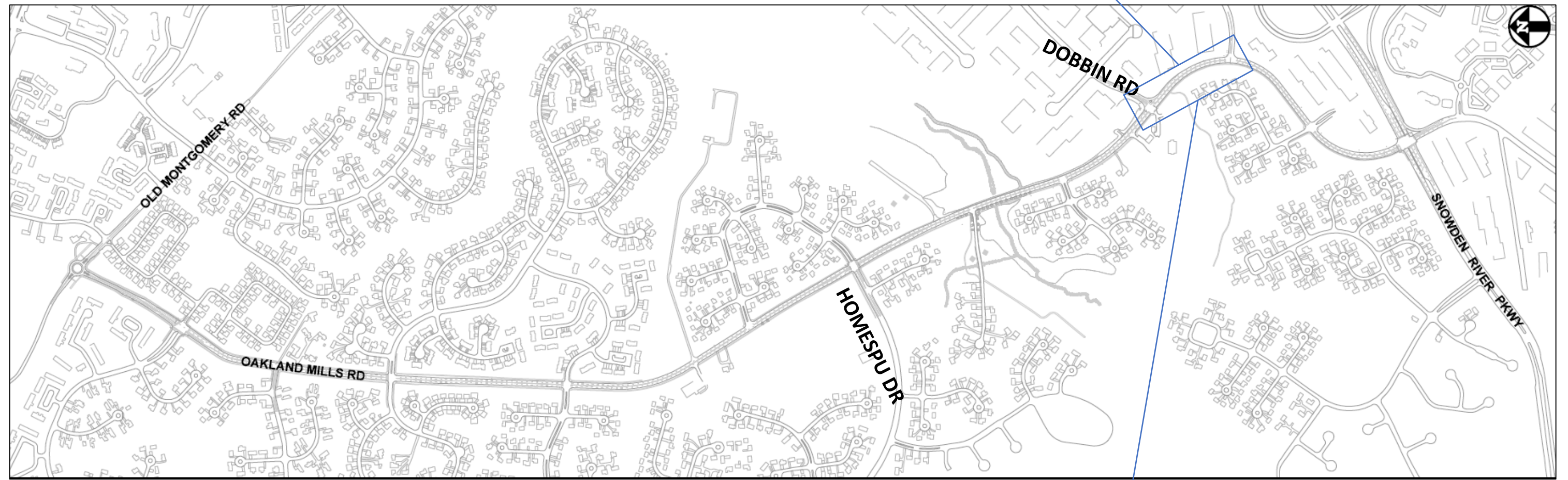

## OPTION 2

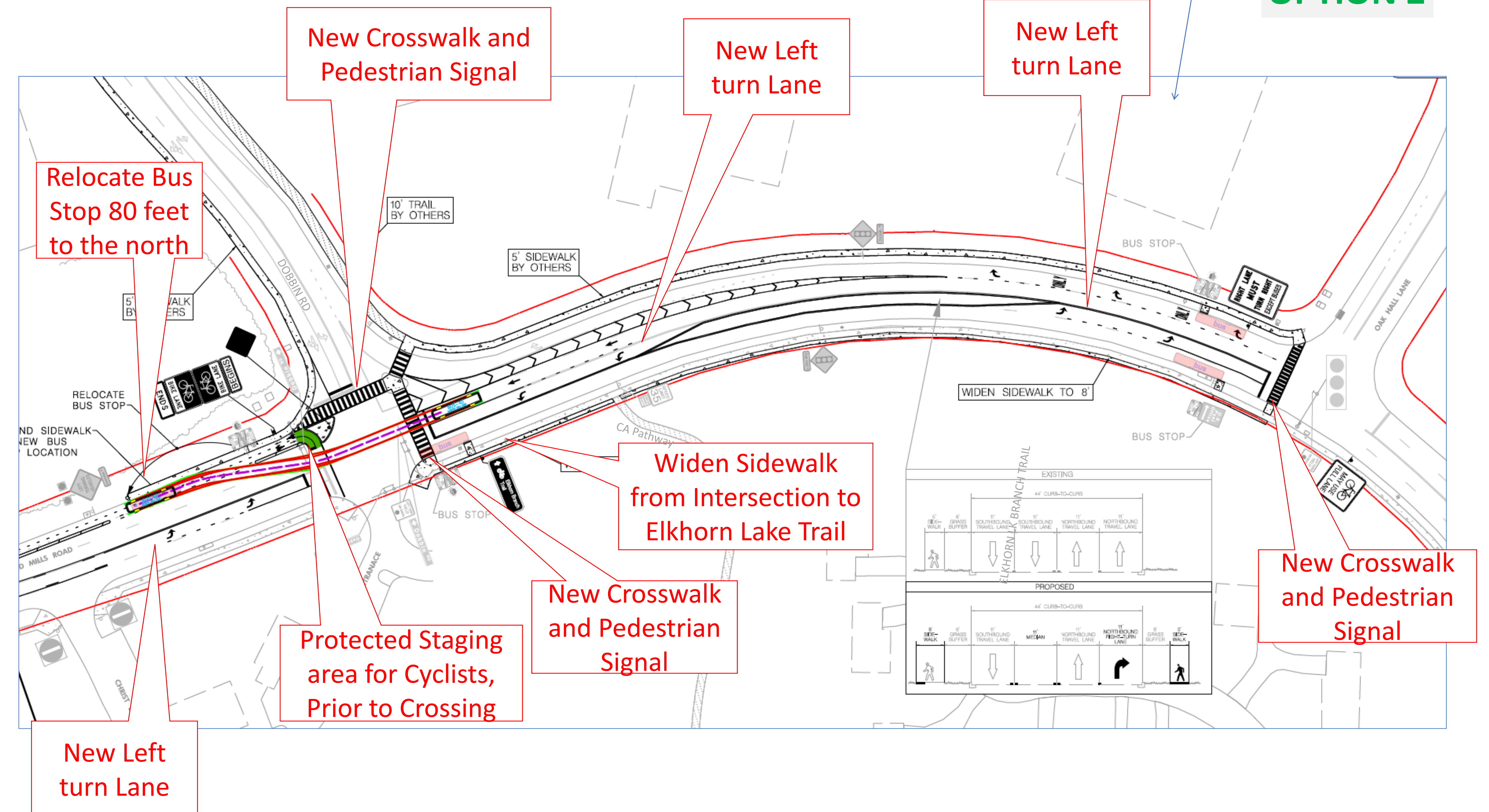

# Oakland Mills Road, Bike Lane Access to Elkhorn Branch Trail

**OPTION 2**



New Crossing for Cyclists

Add Wayfinding Signs

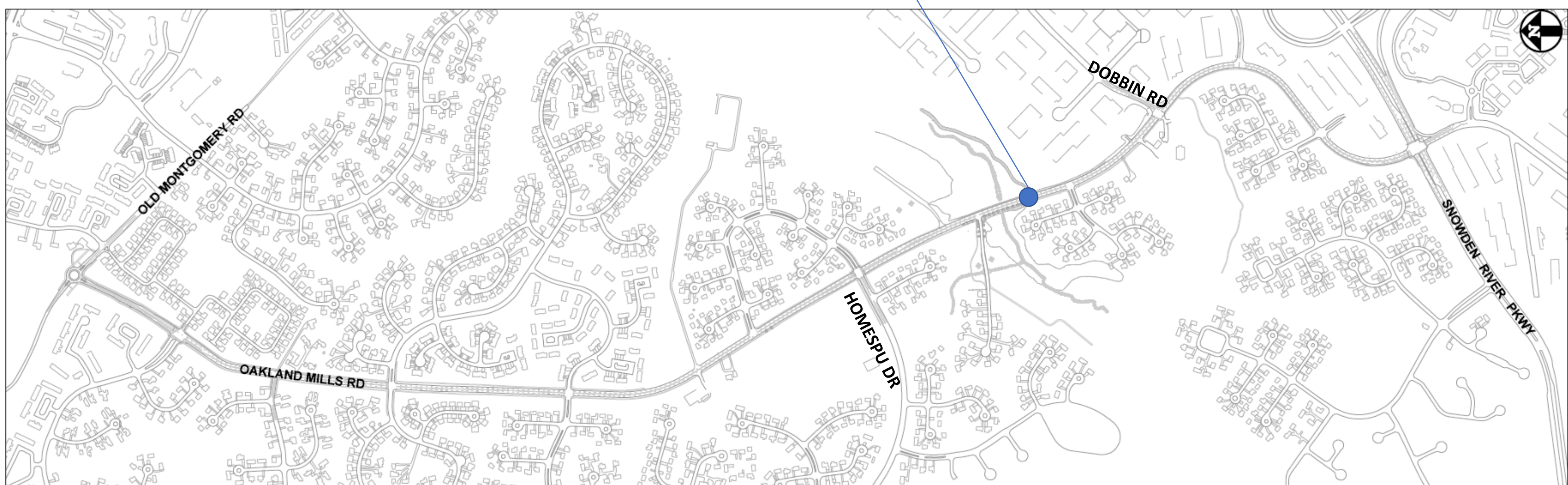
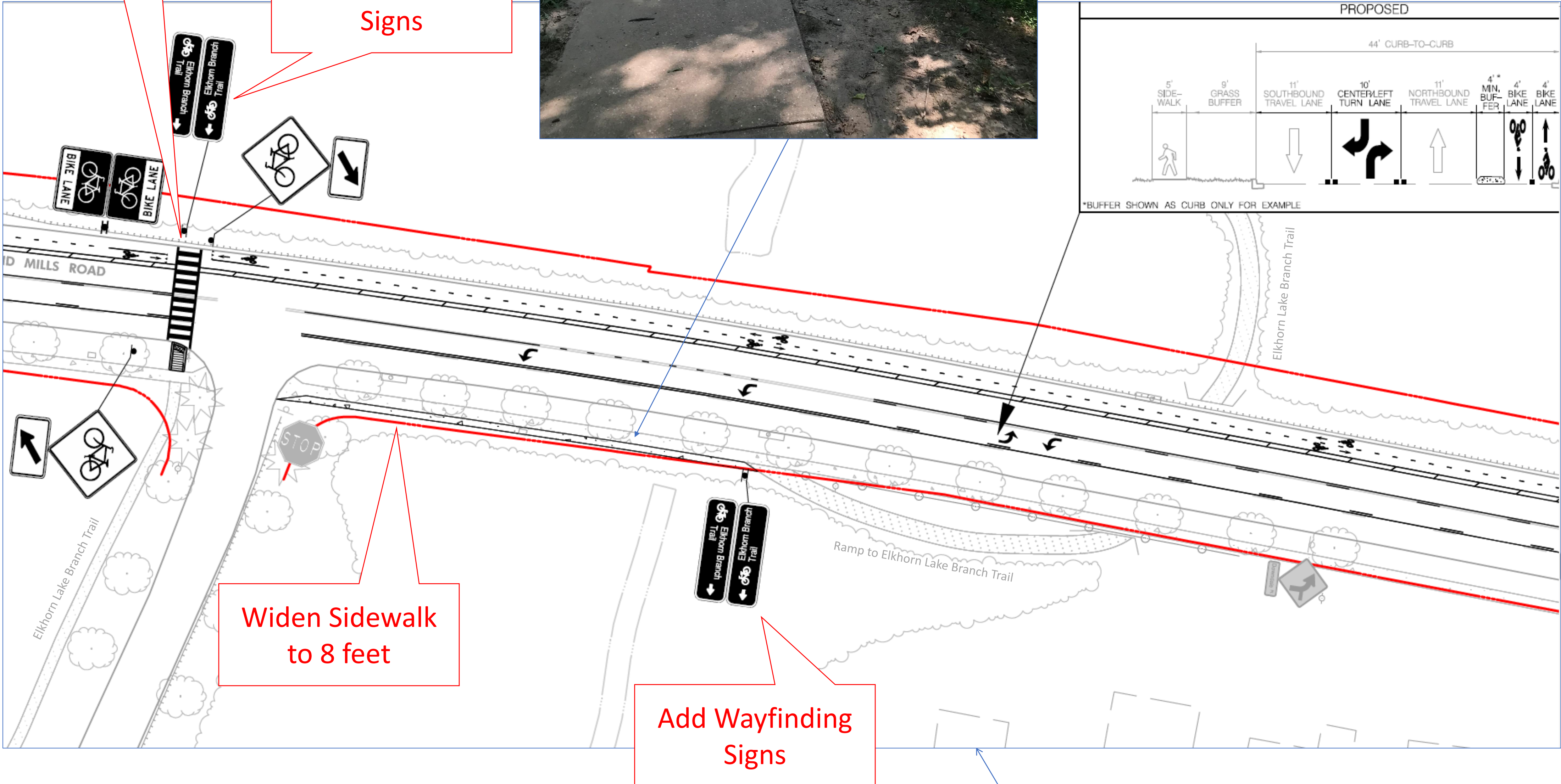
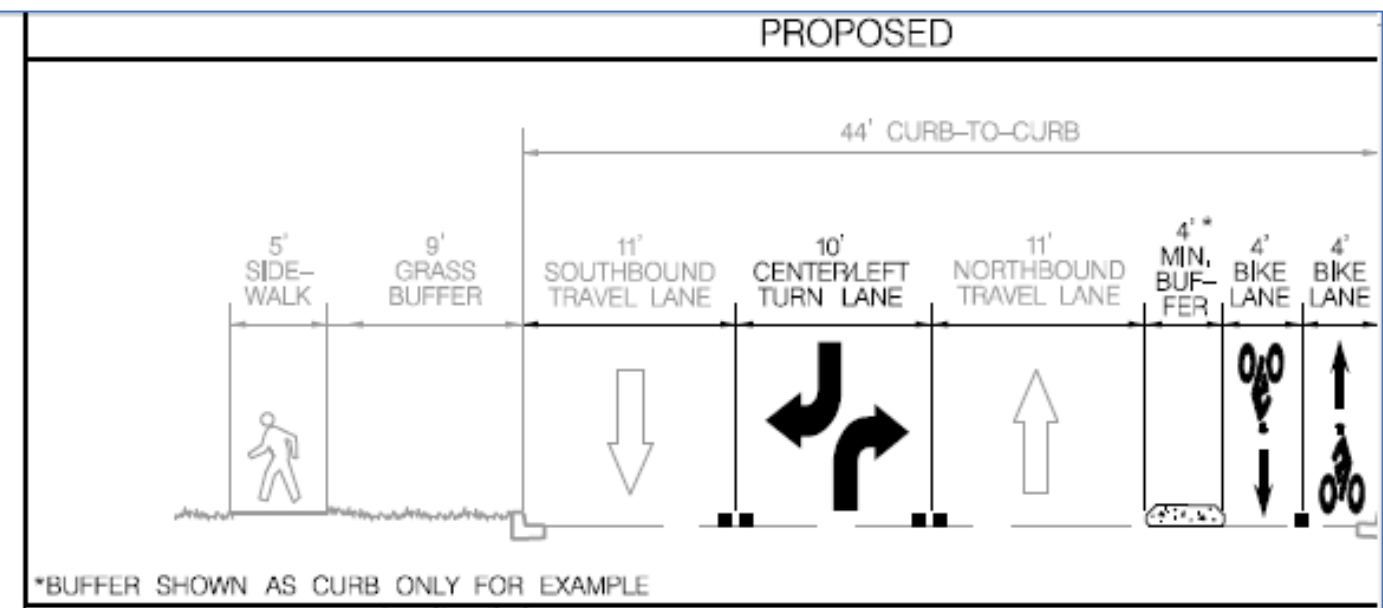

# Oakland Mills Road, Bus Stop with Bike Lanes



Bus Frequency is about every 1 to 2 hours

Stopped Bus will block Bike Lane and General Travel Lane

## OPTION 1

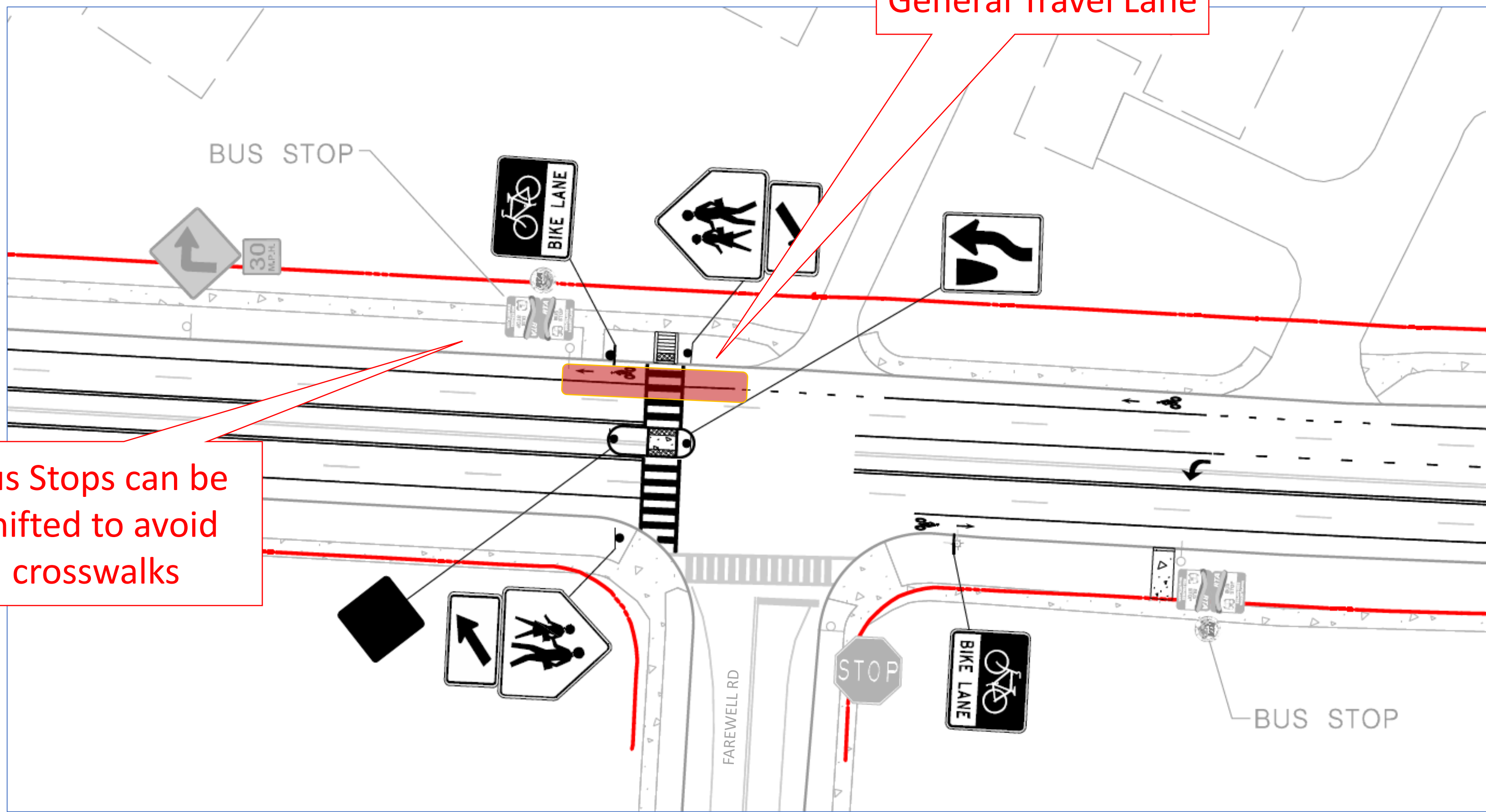

All RTA Buses are required to pull up to a curb to pick-up/drop-off passengers

## OPTION 2

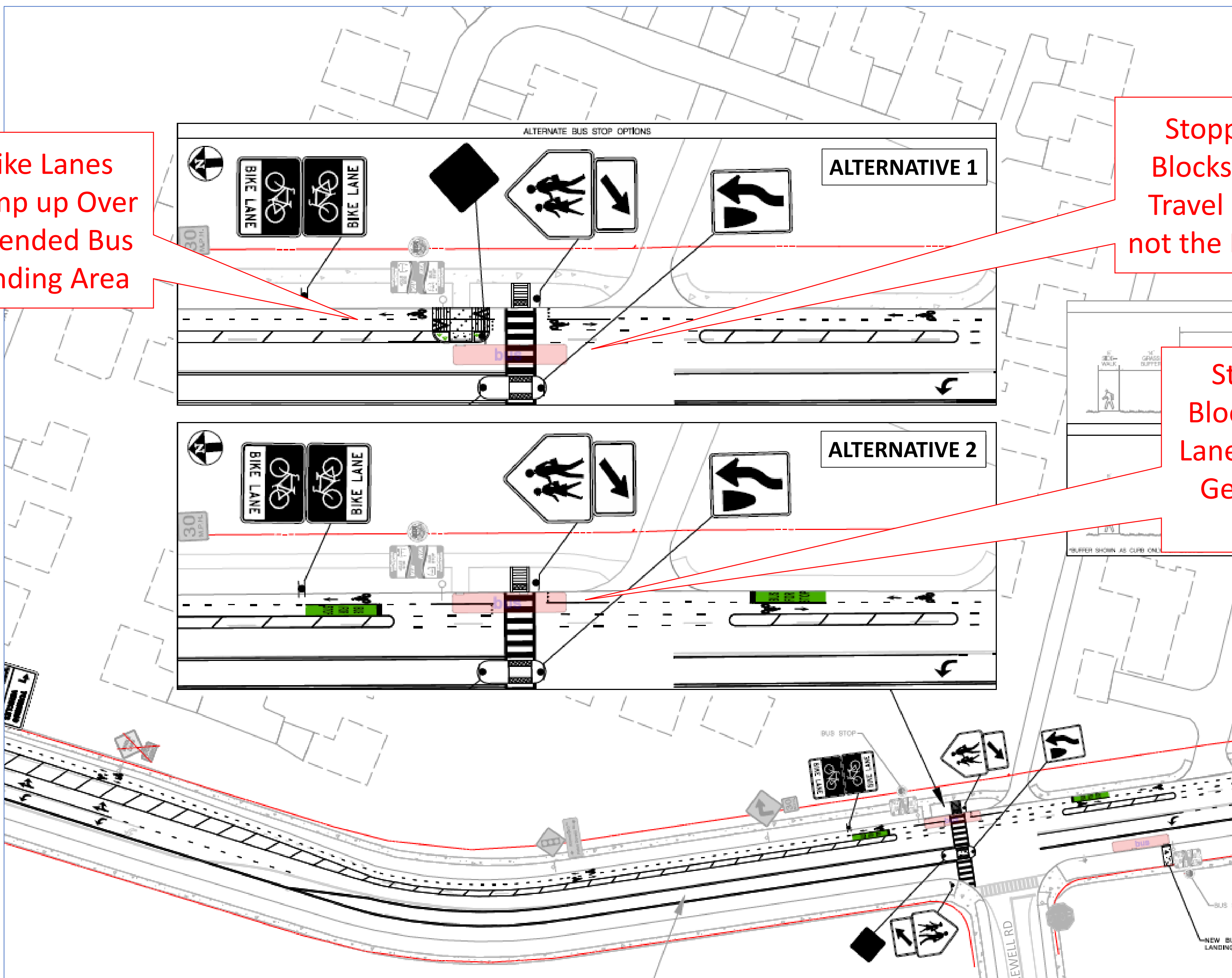

Stopped Bus Blocks General Travel Lane but not the Bike Lanes

Stopped Bus Blocks both Bike Lanes but not the General Travel Lane

Bike Lanes Ramp up Over Extended Bus Landing Area

